

Cityliving™

HOME SOLUTIONS FOR BETTER LIFESTYLES

S\$ 5.00

VOLUME 4 2021



HOME & HEARTH

Organisation tips for better peace of mind

HOME THEATRE 101

Blockbuster-worthy setups for every budget

SHOW & TELL

Get inspired by Gain City's smart showflats!

SO COOL
Ingenious zero-cost air-con tips

ENERGY EFFICIENT
Sustainable solutions for your abode

sanctuary
by design

Make your home
a haven of wellbeing

WORLD OF NAZARIO

A new standard in luxurious,
comfort living with superior sofas



PRODUCTS, PASSION & QUALITY

Our design and production team works passionately hand-in-hand to create different leather sofa collections to fulfil the varied needs and requirements of our customers. Comfort and ergonomics are our top priorities. One of the reasons for our customer loyalty is our consistent quality. Every sofa interior and exterior is crafted with the finest finishing. There is meticulous attention to detail given at every stage of production. Only premium quality materials are used with the latest technologies and skill to produce sofas of uncompromising quality.

GAIN CITY MEGASTORE @ SUNGEI KADUT
71 Sungei Kadut Drive, Singapore 729577

SAMSUNG

INTRODUCING THE NEW **BESPOKE**

Designed for you, by you.



Design your BESPOKE fridge for your way of life

Say hello to an all-new ingeniously-designed line of modular refrigerators that gives you the flexibility to mix and match modules to meet your different needs at every life stage. That's not all, get to style it your way with an attractive palette of hues and finishes. So begin personalising your very own BESPOKE fridge today.

Simply visit samsung.com/sg/bespoke-refrigerators or any Gain City retail outlet.

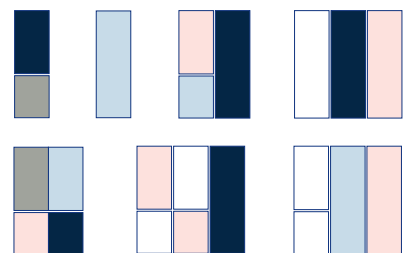

Discover every combination for every lifestyle.

YOUR HOME, YOUR SANCTUARY

Form meets function in more ways than one in this issue of City Living. Tailor your home to seamlessly fit your lifestyle needs with our guides to the latest products, furnishing trends and more.



Our home, which has truly become where we're spending the most time, is more important than ever. Rather than treating it as just another place to live, think of turning the humble abode into a haven that's comforting, relaxing and harmonious no matter the time of day.

In the fourth edition of City Living, we explore practical ways to transform your home into a multipurpose sanctuary built around your lifestyle, as well as informative home improvement tips for your kitchen, dining area, bedroom and more. From our guide to decluttering to setting up your very own Zen Den and creating mindful communal spaces, our insights only serve to enhance your living experience.

The kitchen, being the heart of our home, is a big focus. In this issue, we explore everything from space planning to must-have kitchen companions to help you make the most out of this hard-working room. We also tackle the adjacent

service yard with handy solutions to maximise efficiency and energy consumption.

For folks who are big on ambience and love unwinding to a good movie after hours, find out how to build the best home theatre for your budget, as well as lighting trends to brighten up your sanctuary.

Our home is sacred, and this issue reflects our ongoing quest to help our readers make theirs a feel good space. Till the next issue, stay safe, happy and healthy!

Johanna

**Your Editor,
Johanna**



**MITSUBISHI HEAVY INDUSTRIES
AIR CONDITIONERS**

MOVE THE WORLD FORWARD



HIGH PERFORMANCE RESIDENTIAL AIRCONDITIONING



contents

WHAT'S Essential



- 20 ORGANISED HOME, ORGANISED LIFE**
Decluttering essentials for better mental wellness
- 23 MINDFUL SPACES**
Functional and efficient builds for communal areas at home
- 26 KITCHEN GLOW-UP**
Cook spaces with form and function
- 30 INGENIOUS KITCHEN**
Your must-have cooking companions
- 34 EASY FIXES FOR KITCHEN WOES**
Quick yet lasting solutions for the kitchen

- 36 SETTING UP AN ENERGY EFFICIENT KITCHEN & SERVICE YARD**
Practical ways to reduce your energy bills
- 37 SERVICE YARD SOLUTIONS**
Upsize the functionality of this small space
- 42 LIVING GREEN**
Setting up a home recycling system that works
- 44 MINDFUL MATTRESSES**
The right fit for a great night's sleep
- 50 SLEEPY SPACES**
Start snoozing in every corner of your house

WHAT'S New



- 12 SHARING SPACES**
Interior tips for close quarters

86 COVER STORY



Take a tour of a show flat at Gain City Megastore @ Sungei Kadut with artiste Meixin Macy.

Photography Wong Wei Liang

Featuring Toshiba MS1-TC20SF Pure Steam Oven, De'Longhi Dedica Style EC685.R Pump Espresso Coffee Machine, De'Longhi KBOV2001-GR Cordless Kettle, Toshiba RC-18ISPS Rice Cooker, LG GSX6011NS Side by Side Fridge





SIMPLE MATTE BODY IDEAL FOR YOUR HOME

- SMOOTH DESIGN, SIMPLE AND EASY-MATCHING SENSUAL PLEASURES IN ALL STATUS.
- ALL-CLOSED SEAMLESS DOUBLE AIR LOUVERS KEEP INNER CLEANLINESS.



Black diamond
technology



Multifunctional filter



Cold plasma



3 years warranty



Superior 5
ticks performance



R32 refrigerant

SG Gree Pte Ltd

60 Tannery Lane, Singapore 347803 Tel: 69708871 Fax: 69708873
Sales enquiries: sales@sggree.com.sg Website: sggree.com.sg



WHAT'S Cool

- 54 SET UP YOUR HOME FOR CHILLING SUCCESS**
Staying cool indoors starts here
- 64 EASY & BREEZY**
Avoid these air-con mistakes
- 66 FREQUENTLY USED A/C MODES, EXPLAINED**
How to truly maximise your air-con functions
- 69 BREATHE EASY**
Our guide to zero bad air days

WHAT'S Special

- 93 GOING GREENER WITH GAIN CITY**
Turning e-trash into recycled treasures since 2018
- 95 HOME SWEET HOME**
Exclusive packages for new homeowners
- 96 FAMILY CARD**
Perks from Gain City's loyalty and rewards card



WHAT'S Smart

- 72 TINY BUT MIGHTY**
Smarten up with small high-tech home upgrades
- 74 HOME OFFICE ESSENTIALS**
Top WFH essentials for maximum productivity
- 79 ZEN DEN**
Unwind with smart home appliances that do the work for you
- 80 BRIGHT IDEAS**
Top lighting trends for your home
- 82 HOME THEATRE SETUPS FOR EVERY BUDGET**
The ultimate home cinema experience starts here

WHO'S Home

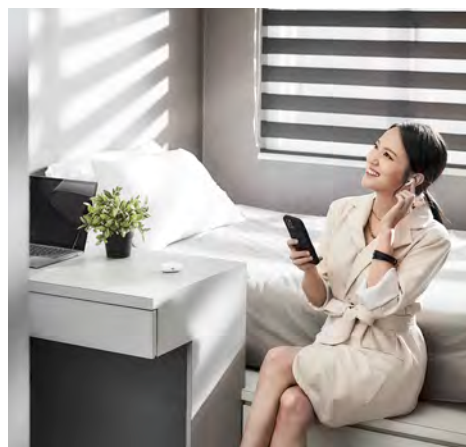

- 86 CELEBRITY TOUR**
Tour a Gain City show flat with artiste Meixin Macy

PHILIPS

Airfryer XXL

Premium

The Healthier Way To Fry
90% less fat*
100% taste

HD9860/91



**Compared to fresh fries prepared in a conventional Philips Fryer.*

PHILIPS

sonicare

9900 Prestige

Always get it right

with intelligent SenselQ technology

up to **20x** plaque removal*

up to **15x** healthier gums*



innovation  you

**Versus manual toothbrush*





CITYLIVING.COM.SG

PUBLISHER

Kenny Teo

EDITORIAL PUBLISHER

Walter Lim

DIGITAL MARKETING

MANAGER

Ivan Sim

TECHNICAL ADVISOR

Teo Meng Hwee

EDITOR

Johanna Teo

DIGITAL MARKETING

Gerald Foo

Irlynn Adrianna

CONTRIBUTORS

Cher Yeo

Chew Hui Ling

Ho Li Yen

Jolin Koh

Rachel Annabelle Chong

Valerie Teo

Wong Wei Liang

PROJECT MANAGEMENT

Foo Mei Siah

Callyn Poh

ART

Cally Han

CITY LIVING™ IS PUBLISHED BY

GAIN CITY BEST-ELECTRIC PTE LTD

8 Ang Mo Kio Industrial Park 2, Singapore 569500

Tel: +65 6565 1212 | Fax: +65 6555 1212 | Website: www.gaincity.com

Business Registration No. 199304709Z

PUBLISHING CONSULTANT

MEDIA GROUP PTE LTD

For advertising enquiries: advertising@cityliving.com.sg

Printer & Colour Separation: KHL Printing Co. Pte Ltd
Distributor (Singapore): Singapore Press Holdings Limited

MCI (P) 003/10/2021. City Living™ Magazine is published by Gain City Best-Electric Pte Ltd (Registration No. 199304709Z). Copyright of the material belongs to Gain City Best-Electric Pte Ltd and all rights are reserved by said party. This publication, in part or in whole, is not to be reproduced, stored, and transmitted, digitally or otherwise, without prior consent of the publisher. The views and opinions expressed or implied are those of the authors or contributors and do not necessarily reflect those of the publisher. Although all precautions have been taken, we shall not be held liable for any actions taken based on views expressed, or information provided within this publication.

© 2018

CITY LIVING GOES DIGITAL!

100 PAGES OF HOME PRODUCT SHOPPING KNOW-HOWS AND HANDY TIPS,
PLUS INSPIRING HOMES AT YOUR FINGERTIPS. FREE DIGITAL COPY, OUT NOW!



Scan the QR code or visit cityliving.com.sg to read
or share past issues from 2019 to 2021!



WHAT'S **New?**

NEW & NOTEWORTHY

The latest & greatest in home tech, appliances & trends.

The new Surface Laptop 4

Style and speed

with free upgrade to Windows 11

**GAIN CITY
EXCLUSIVE**



Purchase Surface Laptop 4* at \$2,249 and receive a Gift with Purchase – Microsoft Office Home & Student 2019 (worth \$229)

**Eligible specifications: 13.5-inch · 512GB SSD · Intel® i5 · 16GB RAM · Black*



All other software and accessories sold separately.

SHARING spaces

SMALL SPACE LIVING REQUIRES FLEXIBILITY AND CREATIVITY, ESPECIALLY WHEN LIVING IN A HOUSEHOLD FULL OF PEOPLE. BUT DONE RIGHT, EVEN THE MOST COMPACT OF ROOMS CAN SHINE. HERE'S A QUICK DOS AND DON'TS LIST TO OPTIMISE LIMITED SQUARE FOOTAGE TO YOUR ADVANTAGE, ALONGSIDE TIPS TO BUILD COMMUNAL ZONES THAT EVERYONE CAN SHARE COMFORTABLY.



Mindful planning for real life

Creating a space that's equal parts functional and eye-catching begins with precise planning. Start by asking questions to help figure out how to get the most out of that particular room. Consider who will be using the area the most, if extra storage space is needed, or whether to cater for multiple purposes like a study or living area. The idea here is to be thoughtful about how people will use and move through these spaces and plan around each lifestyle.



The Sindy Coffee Table 1186 CT features a classy set of black and white marbled coffee tables that can be easily stacked to reclaim floor space after use. The smaller nesting table even comes with a drawer for extra storage.



Focus on single-purpose rooms

Every inch matters in small spaces, as does making them multifunctional. Think about creating zones that serve many, such as one that functions as a home office, study nook and even dining area. And opt for furniture and cabinetry with multipurpose functions. Even better if these designs can be hidden away until required – for example, a dining table with hidden storage for power sockets and USB ports.



ReDesign your Kitchen Hair style



Remington & Russell Hobbs
ambassador 2021, @gizellegal

Exclusive Distributor:



SERVICE CENTER

Add : 2 Leng Kee Rd,
Thye Hong Centre,
#04-09A, 159086
Tel : (65) 6741 0900



Russell Hobbs
Feel at Home



Russell Hobbs Singapore



russellhobbs.sg

REMINGTON®
EST. NEW YORK 1937



Remington Singapore



remington.singapore



Invest in quality and durability

Furniture in shared spaces is heavily used, which is why going for well-made pieces that cost more, but look better and lasts longer, pays off. Where possible, pick furniture and items with the potential to grow and change with your lifestyle. The **King Koil Sofabed with Storage KLM813** is the perfect piece for rooms that need extra seating – and easily converts into an extra bed for fun sleepovers.



Skive off cleaning

The reality is, smaller spaces require more upkeep as they tend to feel dirtier and messier quicker. Besides setting up a daily cleaning plan that everyone in the house contributes to, consider investing in smart home gadgets that do the heavy lifting for you.



At only 97mm high, the **Samsung Robotic Vacuum** packs a punch. For starters, its sleek design is 28 per cent slimmer than conventional robot vacuums – but it produces 40 times more suction power, making it as powerful as a stick vacuum. It also features a Visionary Mapping™ system and FullView Sensor™ 2.0 function to scan and create the most optimal and efficient cleaning route, so it never gets stuck. Other user-friendly perks include remote Wi-Fi control via the Samsung SmartThings app and a Voice Guide for quicker updates on its status, scheduling and cleaning modes.



Create personal areas

Sharing space in small dwellings can cramp your style fast. We're spending more time indoors than ever, so carving out personal spaces for each household member to catch moments of much-needed peace and relaxation will go a long way towards avoiding conflict. Have an awkward corner in your home? Turn it into a cosy reading nook where anyone can settle in and unwind with a good book. Or, consider using visual barriers like bigger plants or even a screen to provide the illusion of privacy in common areas.



Use colours strategically

It's no secret that light colours make a room look larger, as does natural lighting. Incorporating too much colour can make small spaces feel busier, so opt for a light, monochromatic palette. Paint-wise, try off-white shades like eggshell or dove hues for a warmer, more relaxed feel. Plus, sticking with gender-neutral colours help create more balanced and inviting places for all.



Take your paint job to the next level with Gain City's professional painting services. These experts use premium Nippon paint for better, more lasting results. Visit www.gaincity.com for more details.



Go too large-scale

Our quest for more space and storage can often lead to unnecessary additions like too many open shelves or bulky storage containers that contribute to visual clutter. It may be challenging, especially for families with young kids, but paring down what you own and catering only for those items will go a long way in elevating a sense of spaciousness.



Opt for double-duty appliances and tools

Double-duty furniture and appliances offer more bang for your buck while saving precious space. This concept is most applicable in the kitchen, as home cooks can whip up a wide variety of meals with the proper multi-use gadgets.

Tefal's Versalio Deluxe 9-in-1 Multi Cooker FR4950 is perfect for those struggling with countertop space or lack thereof. Merging the functionality of several appliances – including a rice cooker, fryer and sauté pan – Versalio Deluxe adds versatility to your cooking routine. Set the fryer's temperature from 80 to 180 degrees Celsius, and choose from nine different modes to defrost, simmer, fry, braise, sauté, deep-fry, boil pasta or cook rice. Clean-up is fuss-free, too – the lid, non-stick bowl and frying basket are all dishwasher-friendly.



Consider a semi-open floor plan

Get the best of both worlds with a semi-open floor plan that allows for better light and traffic flow while maintaining some pockets of privacy around the house. Homeowners who wish to create distinct zones in communal areas without extensive renovations can use larger pieces of furniture like a sofa or bookshelves to divide the room without cluttering it up.





96 INTERIOR PTE LTD

50 Ubi Cres, #01-10 Ubi Techpark, Singapore 408568 | Tel: 93219696



THE DESIGN YOU DESERVE



SCAN THE QR CODE
TO FIND OUT MORE
ABOUT OUR INTERIOR
DESIGN SERVICES



RENO REWARDS

Engage our services now
and get up to

\$2,000

worth of

Gain City Vouchers*!

*Terms and Conditions Apply

www.96interior.com.sg

LUXURY IN NOIR

96 Interior's reimagining of this humble HDB dwelling sees the perfect balance of sophistication, luxury and a hint of rugged earthiness.

Putting a dramatic spin on the usual purist modern aesthetics, 96 Interior elevates the homeowner's vision of bright and minimalistic sensibilities to one that gently explores the nuances of noir and luxury.



▲ Using tinted glass for the galley-style walk-in wardrobe cleverly adds the illusion of increased space within the bedroom. A large StonelikeStone panel adorns the wall above the bed, adding a ruggedly bold focal point.

▶ A semi-open concept layout makes shared living, dining and home office spaces appear more spacious and modern. Low-lying furniture in earthy shades accentuates the room's height. At the same time, subtle textures like marble and wood are layered over the monochromatic palette, producing an effect that's rich and full of depth. A bespoke, mirror-polished ceiling panel stretches over the living and dining area. The unconventional choice of material adds a cohesive touch.



▲ The integrated kitchen has a near-seamless appearance, with furnishings blending in effortlessly. The cabinets are brought to the ceiling to visually expand the wall, while the design of the vertical slats mirrors the kitchen island for harmonious continuity.

▼ The home office takes on a fantasy vibe with a statement wall emblazoned with a map from Dungeons & Dragons. Strategically placed smart LED strip lights add futuristic elements, as does a sleek, customised workstation with concealed cable storage.

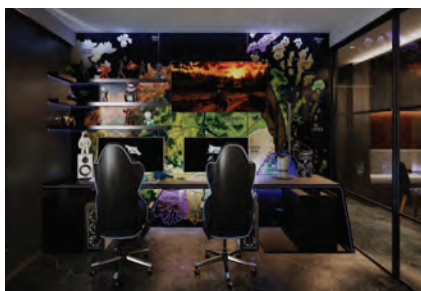

▲ This standard HDB bathroom is upscaled with custom finishings and classy storage units that double as a cover to hide the plumbing. A sink-to-ceiling mirror contributes a sense of spaciousness, while the waterproof wood-laminated shower cubby adds a hotel-chic touch.



WHAT'S **Essential?**

COOK & CLEAN

Covering all your needs for a clean and efficient living space.

LG's first AI Washing Machine that DETECTS • THINKS • CARES



Enjoy 18% more Fabric Care

AI DD™ Direct Drive detects the weight of washing loads and fabric material to identify the optimal washing pattern based on over 20,000 big data.

Thoroughly clean in 39 minutes

With TurboWash360°, your laundry is thoroughly cleansed with multi nozzles spraying from 4 directions, ensuring high efficiency wash without damaging the fabric.



THE FUTURE IS HERE

**LG leads the ranks with its extensive catalogue of domestic appliances.
Here are two power-packed products to keep your home running smoothly.**

Outfit your kitchen with LG's latest GT-F4781BL Top-Freezer Refrigerator, which brings a host of innovative functions.

For starters, the GT-F4781BL features an in-door water dispenser, an unconventional addition to top-freezer designs. It has excellent temperature control for keeping food and produce fresh with LG's LINEAR Cooling™ function that minimises temperature fluctuations to only 0.5 degrees Celsius.



Complementing the GT-F4781BL is LG's DoorCooling+™, which significantly reduces the

temperature gap between the inner part and door side of the compartment, hence cooling the refrigerator up to 35 per cent quicker than conventional cooling systems. It also features the Hygiene FRESH+™, which eliminates up to 99.999 per cent* of bacteria and odour.

Equipped with LG's unique Inverter Linear Compressor, the GT-F4781BL rates a decent three ticks in NEA's energy rating system and produces minimal noise. Thanks to its sleek black steel exterior that keeps sticky fingerprints at bay, the hardworking appliance looks as good as it performs.

The LG FV1450S2K AI Direct Drive Front Load Washing Machine is an AI-powered marvel that takes the guesswork out of laundry. Its star function, the AI DD™, uses over 20,000 big data from accumulated washing experiences to provide superior care during each cycle.

Enabled by AI DD™, the washer detects the weight and softness of the fabric and intelligently chooses the optimal washing pattern for each load – and provides up to 18 per cent* more fabric protection.

Efficiency is a big focus here, with the inclusion of LG's TurboWash™360° technology. Kitted with 3D multi nozzles that sprays water in four directions to reach every inch of your laundry, the FV1450S2K takes only 39 minutes* to complete each cycle.

Coupled with LG Steam+™, this washer eliminates 99.9 per cent of allergens while keeping garments 30 per cent less wrinkled. The FV1450S2K is also highly energy-efficient, having a four-tick rating on NEA's energy-rating system.



*Detailed disclaimers apply

ORGANISED HOME, organised life

**OUR GUIDE TO DECLUTTERING TO REDUCE STRESS
AND IMPROVE YOUR STATE OF MIND.**



Out of sight, out of mind, or so the saying goes. However, when you're spending so much of your time enclosed within your home and messes are thrown into sharp relief, the simple act of

decluttering does wonders for oneself – not only does it make you feel re-energised, but also improves your productivity. Question is, how do you start and ensure that the home stays neat? Here are our best fixes.



PRO-TIP! If the entryway opens directly into the living area, you can segment the space with a bookshelf or use a partition.

Establish a drop zone

A drop zone, otherwise known as a landing strip, is a dedicated space near the entryway where you can unload your everyday items. Common features include a rug on which you can toe off your shoes, a dish for your keys and niches for your mail. It's extremely helpful in preventing your belongings from winding up in different areas of the home.

Include more built-ins

The key to an organised home starts with your storage. In short, there should be a place for everything and everything should have its place in order to keep clutter to a minimum.

Leaving extra space in a cabinet or getting a generous floor-to-ceiling wardrobe means that you'll always find room for new purchases without re-organising.

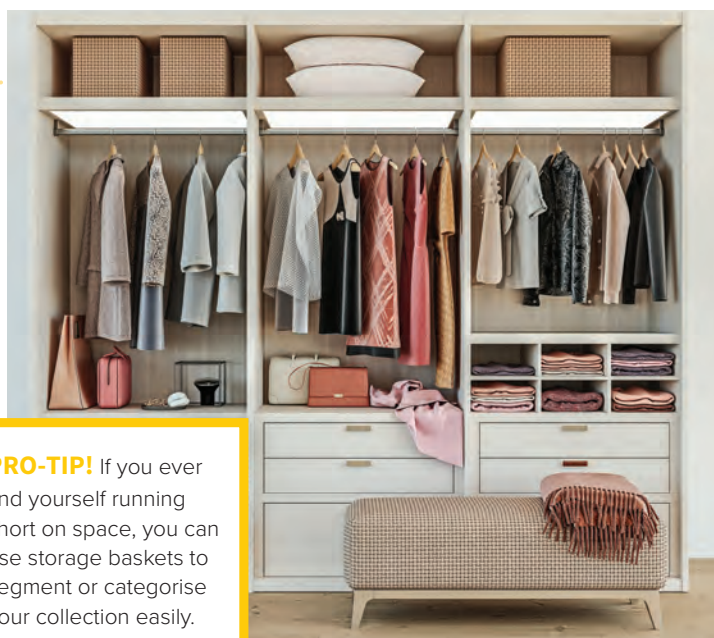

PRO-TIP! If you ever find yourself running short on space, you can use storage baskets to segment or categorise your collection easily.

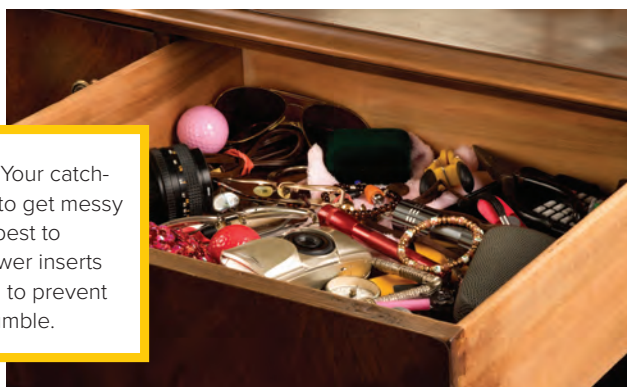

PRO-TIP! Your catch-all is going to get messy fast, so it's best to include drawer inserts beforehand to prevent a tangled jumble.

Plan for junk drawers

The junk drawer is a great boon for those aspiring to have an uncluttered home. Like the name suggests, it's where all miscellaneous items go and stay hidden. Still, stuff will inevitably pile up, which is why having a catch-all in every single room is ideal.



PRO-TIP! Free up countertop space by storing your sponges and scrubbers in organisers, which you can hang off your cabinet knobs.

Utilise vertical racks

When getting more storage space is not an option, adding vertical racks to your doors can help keep your necessities organised. Once closed, it would be completely concealed too, leaving your guests none the wiser.

Introduce pull-outs

Every flat will have its fair share of awkward corners and “dead” zones, which makes maximising your space all the more difficult. With foldaways and pull-outs, you can turn these tricky spots into fully functional storage points, and to keep clutter out of view.

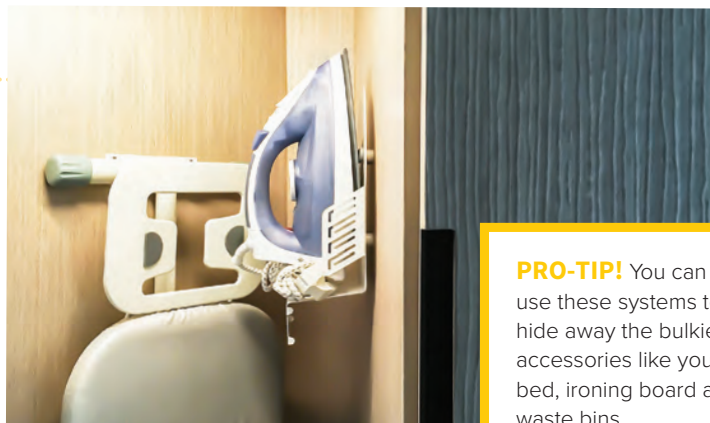

PRO-TIP! You can also use these systems to hide away the bulkier accessories like your bed, ironing board and waste bins.

PRO-TIP! Platform beds are a great way to introduce more storage, but requires more consideration as it is a permanent built-in.



Invest in multipurpose furnishings

Even the furniture you pick out can help you stay organised – settees with seating that can be removed to reveal storage and headboards with built-in compartments are just some examples among many. If you're looking to set up an organised home, multipurpose furnishings are definitely something to look into.

mindful SPACES

ACHIEVE A MORE FUNCTIONAL AND EFFICIENT BUILD FOR YOUR COMMUNAL AREAS WITH THESE TIPS.

It's no secret that the kitchen is one of the hardest working areas of your house, and as an area that sees heavy footfall, it's easy for the space to become a cluttered, chaotic mess.

However, with some pre-planning on the layout and purchasing the right appliances and tools, you can get your kitchen sorted.

Start with storage

No matter the shape of your kitchen, you'll need storage for it to be fully functional. Make sure that there's plenty of vertical and horizontal shelves for your spices, cutlery and appliances. You may consider knob-less cabinet doors for a sleeker appearance or slow-closing options for future-proofing.



PICK THE RIGHT LAYOUT

From U-shaped to galley style, there are many ways to format a kitchen. Still, you should consider your own floor plan to find out which is the most suitable for your space.



Select the right materials

In order for your kitchen and dining area to go the distance, the type of material you choose matters, especially for countertops and built-ins. Great picks for hard-working kitchens include self-cleaning, fingerprint-proof laminates and hardier engineered quartz.



Curate your display

While you might be tempted to squirrel the mess away, having some of your favourite herbs, spices or grains can prove to be beautiful display and a reminder to look after your own wellbeing. Of course, having some of them within arm's reach is undeniably convenient too.



Integrate where needed

You'll want your kitchen or dining area to be as functional and hard-working as possible, but space can become a constraint. There are appliances like your dishwasher as well as pull-outs that can be fully integrated into your cabinets to serve as additional work spaces. When not in use, simply close it up for a neater appearance.

Use your kitchen island more

The kitchen island can be used for so much more than just prep work, provided that you get it outfitted correctly. If it doubles as your work station, you could install more power points for your devices. Otherwise, you could put in a mini wine cooler, integrate a sink or a downdraft hood for entertaining, cooking and dining purposes.



CREATE A NOOK

You can extend the carpentry outwards to frame your bench up, creating a cosy dining area that effectively doubles as your home office.

Install benches

While standalone chairs do keep things pretty flexible in terms of layout, a bench offers more functionality – you're able to install pockets within the seating for additional storage space or work in more power points.



Glass is right

An enclosed kitchen makes you feel stifled, yet the open concept kitchen cannot keep the fumes contained. With glass doors and folding screens, you can have the best of both worlds: the feeling of spaciousness plus a way to keep the grease out.

THE PERFECT HOME FOR FINE WINES

Whirlpool
Every day, care.

Whirlpool's new Wine Cooler series is the perfect home for your fine wines. The **anti-vibration design** helps provide a stable environment for your wine storage while **low thermal emissivity glass door** blocks UV rays and heat by up to 75%, creating the optimum environment for your fine wines.

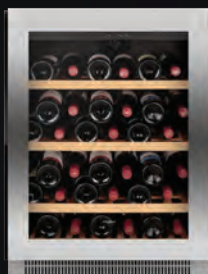

ARC1501
48 BOTTLE CAPACITY
FREE-STANDING OR BUILT-IN



ARC1401
27 BOTTLE CAPACITY
FREE-STANDING OR BUILT-IN



Anti-freeze Configuration

only applicable to ARC1501



Interchangeable Door Hinge

A FINE HOME FOR FINE WINES

Store your wines like a pro with Whirlpool's ARC1501 and ARC1401 wine coolers.

Mastering the delicate art of storing and ageing wine starts by investing in proper storage. Whirlpool's premium suite of wine coolers, the ARC1401 and ARC1501, gets the job done and shows off your collection in style.

Standing at a 27 and 48-bottle capacity (standard Bordeaux bottles), respectively, the ARC1401 and ARC1501 are great for aspiring wine connoisseurs with modest collections.

Both are single-zone coolers with a compressor cooling system that keeps internal temperature stable for optimum wine conditions. Users can adjust between constant temperatures of 5 to 18 degree Celsius to suit varying types of wine storage needs. Plus, the ARC1501

comes with an additional antifreeze configuration, preventing wine from frosting should malfunctions occur.

Another perk that comes with Whirlpool's compressor cooling system is its anti-vibration design. For the uninitiated, even short-term exposure to vibrations from the surrounding environment impacts wine and alters its flavour. The innovative system tackles that often-overlooked factor without compromising your wine's quality. Worth mentioning is the double-coated,

low thermal emissivity glass door that helps block 75 per cent of UV rays while maintaining good visibility of your wine collection.

Beyond its technical features, these wine coolers sport sleek yet versatile designs that wouldn't look out of place in luxury kitchen installations. A flushed door design and interchangeable hinges mean users can seamlessly conceal their wine cooler in a cabinet or feature it as a sleek standalone furniture piece.



KITCHEN glow-up

**WHO SAYS YOU HAVE TO COMPROMISE AESTHETICS FOR FUNCTIONALITY?
HERE'S HOW TO IMPROVE YOUR KITCHEN TO ACCOUNT FOR BOTH.**



Island remodel

When it comes to the design of your island, you'll need to consider its functionality. If you're planning on using it as a dining area, your cooktops and sinks should be placed a safe distance away.

Need to use the island to function as an additional worktop? Choosing a harder surface material will do wonders for its longevity, but it could also look aesthetically pleasing if you have it drop vertically down the sides for a continuous flow to the floor.

Alternatively, you can build in storage niches into the island to house your cutlery, utensils and mini appliances if you need more storage space.



Innovative gadgets

Upgrading your kitchen set-up is a simple way to expand your kitchen's capabilities without remodelling, and these finds take the cake.

FOR VERSATILE BLENDS

Whip up healthier, delicious beverages, soups and even porridge with the **Midea MJBL12K31W2 Blender**. This versatile appliance pairs razor-sharp 8-leaf stainless steel Krupp blades with intelligent heating technology to retain nutrients while delivering fragrant, finer tastes without the risk of charring. It's safe and simple to use, with a food-grade borosilicate glass container that's thermal shock resistant, and a sleek touch screen for easy access to its many menu functions.

VERSATILE HOT POT

Cornell's Grill Pan with Steamboat CCGEL88DT is a must-have for folks who love to have people over for food. Be it barbecue, grill or shabu shabu, this versatile appliance does it all while saving cooking time with individual temperature controls for grill and steamboat functions. Most importantly, the clean-up is hassle-free with its easily detachable parts.



BOSCH
Invented for life

Simply leave the dishes to your tablet.

Your mobile device knows best how to do the washing-up. Thanks to Home Connect with the Easy Start function, it now suggests the ideal settings for each load – easily via app. This way you will always have the best washing-up expert in your house. That's what we call: Smart today. Smart tomorrow. More smart ideas at www.bosch-home.com.sg



*Source Euromonitor International Limited; volume sales 2020

SPARKLING CLEAN

Get the most bang for your buck with Bosch's smart Home Connect dishwashers.

Investing in a high-quality dishwasher saves you time and effort – and contributes to lower utility bills, as it can help conserve energy and water. As one of the world's most reliable dishwasher brands, Bosch's offerings are well-designed workhorses that look great in any kitchen.

The Home Connect Dishwasher range comprises eight powerful models that provide convenience alongside a powerful array of intelligent functions and programmes – easily accessible through Bosch's Home Connect app.

The SMV6ZCX42E, in particular, is as practical as it is aesthetically pleasing. It boasts the PerfectDry function, which uses Bosch-exclusive Zeolith technology to absorb moisture and dry dishes to perfection, with less energy usage.

The fully integrated dishwasher also features a thorough cleaning zone for



heavily soiled items in the upper basket. Paired with Bosch's EcoSilence Drive function, intense dishwashing cycles are whisper-quiet. Just opt for the Silence on Demand feature via the Home Connect app.

Appliance maintenance is simple, too. Just pop one Finish Tablet into the detergent dispenser for each cycle.



Homeowners can now redeem three packs of Finish Tablets upon successful pairing of their Home Connect appliances.



Scan the QR code to find out more!

Power play

The modern-day kitchen is, arguably, the most power-hungry room in your house. As such, it should be outfitted with outlets, not just to power your toasters, kettles, ovens, coffee machines, fridge or mixers, but also your mobile devices.

While essential, they can be quite the eyesore. To get around this you can build them behind little trap doors, tuck them under your cabinets, camouflage them with a wall covering or get a specific plate cover to match your home's design elements.



Backsplash flair

As a vertical panel installed behind your workstations, the backsplash covers the area of the wall between the countertop and cabinets, protecting them from damage and deterioration. In addition to its utility, the backsplash has recently become an added focal point too, and you can use some of the trendier options like mermaid tiles or screen-printed glass to great effect.

Veto wire clutter

Having crisscrossing wires strewn all over the countertops always adds to the visual clutter, especially in a chaotic area such as the kitchen. You can nix wire clutter with the help of sliding power sockets or recessing the outlet box – the former lets you pull your electric outlets over to your appliances while the latter allows you to plug in a gadget and flush it against the wall, covering it from view.



Brandt



DREAM TEAM

Elevate your cooking experiences with these top-notch products from Brandt.

Brandt's suite of kitchen appliances is hard to beat. Whip up delectable meals with Brandt's built-in BXP6555X Multifunction Plus Pyrolytic Oven, designed with plenty of smart features for delicious results.

Temperature is critical for quality, and the BXP6555X makes it hard to go wrong. It has eight cooking functions, including an assisted cooking feature, which recommends the ideal temperature settings for each mode. Even better, Brandt's exclusive Omega Grill and Quattro Pulse technology ensure even heat circulation for the best cooks and bakes.

Dread cleaning up? The oven features Brandt's patented Pyro-Express function, which decimates grease, dirt, or food remains in 59 minutes using residual heat from cooking. This time-saving mode is 50 per cent more economical than conventional pyro-cleaning processes.



The oven combines style and function with a classic stainless steel exterior and soft-closing door lined with four layers of glass so that it stays cool during cooking or pyrolysis.

Transform your kitchen adventures with Brandt's BPI6309B induction hob. Ultra-speedy and easy to clean, this three-zone hob is set in a sleek Vitroceramic glass panel with touch-sensitive controls for its 10 power levels. Each zone offers varying high heat capacities of up to 3.1 kilowatts for even more flexibility while cooking.

Users can opt for its Boost function, which provides instant access to the maximum power of each zone. It also has a timer feature, allowing cooks to programme their desired duration for a fuss-free experience.

In keeping with Brandt's high safety standards, the induction hob comes with 10 safety measures, including a residual heat indicator and anti-overflow feature.

The perfect additions to your kitchen, the Brandt BXP6555X and BPI6309B, are granted the "Origine France Garantie" label. Each offers a two-year standard manufacturer warranty from the point of delivery.



INGENIOUS kitchen

TAKE THE HASSLE OUT OF PREP WORK, COOKING AND CLEANUP
WITH THESE MUST-HAVE KITCHEN COMPANIONS.



De Dietrich's Downdraft Hood DHD7561B is a slim machine that can be discreetly installed between hobs, without any compromise on its performance.

Sleek functionality

When it comes to heavy cooking, you'll need the help of a hood for ventilation purposes and food odour removal.

If you're tight on space, however, working one into the home becomes quite a task as many tend to lean on the clunkier side.

Enter **De Dietrich's DHD7561B**. Marrying performance and innovative design, this downdraft hood can be installed between your hobs, sitting indiscreetly in place until you need it to absorb vapour and steam – consuming 85 per cent less electricity as it does so.

If there are large amounts of vapour or fumes present and you need maximum extraction speed, there's a boost function to amplify the machine's efficiency as well.



MODERN KITCHEN FOR THE CULINARY MAESTRO

Flex your cooking prowess in style with our sleek glass induction hob and chimney hood. Ariston's cooking range makes dining at home an epicurean experience with minimal clean-up and cooking odours.

Chimney Hood: AHBS 9.7F | Induction Hob: NIG 720

KITCHEN DREAM

Ariston offers convenience and culinary excellence from your kitchen.

Induction hobs have revolutionised home cooking – offering more energy efficiency, better safety, convenience and smarter features in one sleek package. Ariston's Induction Hob NIG720BS is a stellar option for gourmet chefs and casual cooks alike with its 73cm, two-zone induction cooktop.

The perfect fix for busy kitchens, the hob is equipped with a durable, Schott Ceran premium glass top that can withstand high temperatures of up to 700 degrees while being thermal shock and high-impact resistant. Cleanups are fuss-free, too. Schott Ceran glass is highly resistant to chemicals and scratches, so users won't have to worry about cleaning agents (or a heavy hand) ruining the glass top.

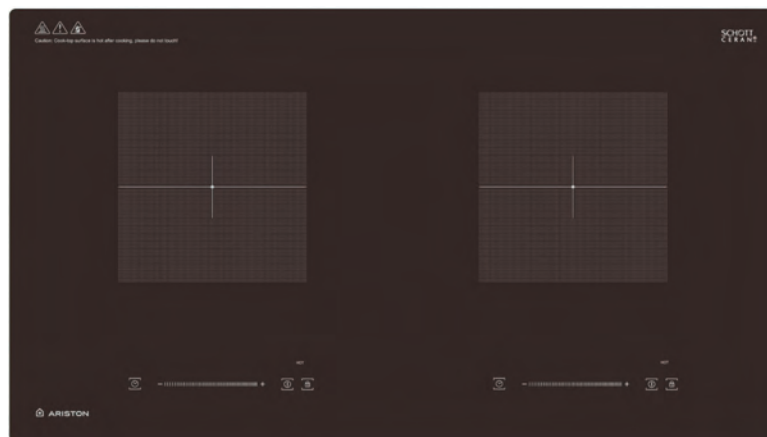

Whipping up complex dishes? The hob's cooking zones are activated by intuitive slider touch controls, allowing independent temperature and function control over each zone for more precise cooking.

Another practical bonus with this Ariston hob is a standard three-pin 13 amp plug that allows users to do away with complicated wiring. Hob installation is kept flexible with dual options for either a built-in or tabletop setup – and fuss-

free thanks to its plug-and-play feature. Just plug it into a power socket and start cooking!

Complete your kitchen with the Ariston Chimney Hood AHBS 9.7F LTI X. It comes with all the bells and whistles: a timed booster mode to suck up unwanted smoke and odours for fresher air in seconds and the flexibility to choose from four levels of sound control (it goes as low as 35db) to keep your cooking activities whisper-quiet.



Best of everything

Renowned for its award-winning appliances that boast quality and functionality, **LG's Side by Side Fridge GFQ6011MC** promises to do just the same and more.

Its revolutionary Inverter Linear Compressor provides up to 32 per cent in energy savings, top-rate 20-year durability and optimal temperature control to keep foods fresher for longer. More importantly, it comes with Hygiene FRESH+™, which automatically cleans and purifies internal air. At the same time, its five-step layered filtering system removes odour components and up to 99.999 per cent of bacteria from ingredients.

Performance aside, its convenience is nothing to scoff at either. It offers remote, hands-free control with LG ThinQ and comes equipped with LG's InstaView Door-in-Door™ design that allows users to knock twice on the glass to view fridge contents without cold air loss.



Medal kettle

Love tea? Take your brews a step further with the **Philips Nourishing Kettle HD9450/81**.

What sets it apart is its unique low-temperature brewing technology that preserves more antioxidants, nutrients and essence from floral tea while amping up aroma and taste. The multi-tasking kettle has eight programmes for users to whip up herbal teas and soup, congee, and even yoghurt. Of course, its health and safety features are top-notch too. It's fashioned out of thick glass and equipped with Strix temperature control for even safer use.

How to extend the life of your appliances

Little things you can do to help your home appliances last longer instead of shelling out big bucks for replacements every so often.

1. CLEAN OUT YOUR FRIDGE AND FREEZER REGULARLY

Believe it or not, you can have too much food stored in your fridge. A bit of airflow is needed to keep the appliance at optimum cold temperature, so clearing out leftovers are a must. Also, tend to the condenser coils at the back of your fridge – once clogged with dirt and dust, the coils can't efficiently release heat and works harder to do so. It's recommended to clean the coils at least once a year, and you can do it with a long brush or vacuum.



2. GIVE YOUR OVEN A GOOD SCRUB DOWN

Like most appliances, the best way to extend your oven's lifespan is to clean it thoroughly. Leaving baked or burned food can cause the heating elements to work harder to cook, making them burn out faster. Some heavy-duty cleaners can ruin heating elements, which is why vinegar and baking soda remain as popular choices to get the gunk out. Metal scrapers are also a no-go because they can cause damage to the protective coating. Instead, use a plastic or silicone alternative.

3. CLEAN YOUR KETTLE FREQUENTLY

The exterior of an electric kettle is simple to maintain, but don't wash it under running water – just give it a good wipe with a clean cloth. The interior, however, is more complex. Start by unplugging it, making sure that it's cooled down, then fill the kettle with warm water and a bit of vinegar.

Let the mixture sit for about 20 minutes before using a scouring pad to scrub it thoroughly of limescale. Lastly, wipe the remnants away with a soft cloth.

4. GET RID OF BUILT-UP DIRT FROM YOUR HOOD

Because of the way it's positioned, the hood builds up fat and grease over time, making it unsafe and unhygienic. How regularly you have to clean is dependent mainly on the number of hours you spend cooking.

Refer to the manual that came with your hood to remove the filter and parts. The fans are best cleaned with a soft cloth dipped in mild detergent and warm water. The same goes for the main body of the hood. For more stubborn dirt or hard-to-reach crevices, use an old toothbrush.



HANDY HELPERS

Start the day right with Russell Hobbs and Remington's home and haircare appliances.

When it comes to kitchen appliances, Russell Hobbs' offerings are hard to beat. After all, the household brand is responsible for bringing the world its first automatic electric kettle, alongside other innovations like the automated percolator and fully programmable kettle.

Since then, Russell Hobbs has expanded their catalogue to include other home appliances. And their products are as functional as they are stylish – perfect for homeowners looking to spruce up their kitchen.

Breakfast Makers

Kickstarting the day right is easier with the Russell Hobbs Luna Copper Accent Breakfast Set. It comprises three hardworking appliances: the Luna Quiet Boil Kettle, Luna 2-Slot Toaster and Luna Filter Coffee Maker decked out in premium stainless steel with alluring copper accents.

Luna Quiet Boil Kettle

Thanks to its quiet boil technology, prepping hot beverages with the Luna Quiet Boil Kettle is a breeze (and kept whisper-quiet). Besides allowing users to boil a cup of water in just 55 seconds, the kettle includes an internal widget with precise markings for up to three cups worth of boiled water. Being able to boil just the amount of water required can save up to 66 per cent of energy! And it comes with a 360-degree base that not only allows for flexible right or left-handed usage but also has space for cord storage.

Luna 2-Slot Toaster

The trusty Luna 2-Slot Toaster is a gamechanger for folks who'd like to avoid

the morning rush. For a start, it can toast bread up to 55 per cent faster than standard toasters. It also features extra-wide slots for users, alongside bread centring guides to ensure evenly browned toast on both sides. Want even more precision? Pair the toaster's adjustable browning control function with its "lift and look" feature, allowing users to check on their toast without cancelling the cycle.

Luna Filter Coffee Maker

Equipped with a 24-hour programmable timer, the Luna Filter Coffee Maker enables users to awaken to the scent of freshly brewed coffee. Don't worry about having to refill its water tank constantly – the glass carafe has a 1.8-litre capacity, allowing users to make up to 14 cups of coffee in one sitting. Each cup boasts a richer flavour and less waste, thanks to its advanced showerhead technology that captures and dissolves more coffee grounds.

Haircare Pioneers

Renowned American personal care brand, Remington, has come a long way since its inception in 1937. As one of the pioneers in men's grooming, Remington's inclusive focus on advanced technology and trends has culminated in extensive personal care solutions for all – from styling to shaving and grooming.



Fabulous Hair Heroes

Be it sleek tresses or a fresh blow-dried effect, achieve the hairstyle you desire while protecting and conditioning your mane with Remington's Keratin Protect Series.

AC8820 Keratin Protect Hair Dryer

Specifically designed to provide hair with three times more heat protection, enjoy salon-standard blow-dries from the comforts of your home with the AC8820. It features a keratin and almond oil-infused conditioning ring that slowly nourishes hair while styling. Plus, it's equipped with a ceramic coated grille for fast heat up and even heat distribution, as well as an ion generator, which produces 90 per cent more frizz-defeating ions for bouncy, healthy-looking results.

AS8810 Keratin Protect Rotating Air Styler

Pressed for time in the morning? Opt for the AS8810, a two-in-one hairdryer and brush tool with keratin and almond oil infused into its advanced ceramic-coated barrels for shiny, high volume hairstyles. The innovative tool comes with 40mm and 50mm thermal mixed bristle brushes. It features 1000w power for fast-drying and a two-way rotating switch that allows users to select their preferred curl direction.



S8598 Keratin Protect Intelligent Straightener

It is possible to have healthy-looking, straightened hair without subjecting your tresses to damaging high heat. Just opt for the Remington S8598 – a revolutionary hair straightener that's able to detect and adjust its heat settings according to your hair's unique moisture levels and providing up to three times more heat protection. This handy tool is also equipped with advanced ceramic plates infused with keratin and almond oil for smooth, frizz-free tresses.

Easy fixes FOR KITCHEN WOES

KISS ODOURS, BLOCKAGE, SPACE CONSTRAINTS AND POOR LIGHTING GOODBYE WITH THESE SOLUTIONS.



Every home faces day-to-day problems, but the kitchen is even more prone – as one of the busiest and most hardworking places, it's essential to have an organised and well-planned layout for easy maintenance. Not sure where to start? Here's a guide to resolving frequent kitchen troubles.



Odour in the fridge

Crammed with produce and leftovers, refrigerator smells are bound to happen. And leaving it will make the odour situation far worse. When faced with such an issue, you'll need to remove everything from the fridge and weed out the expired or spoiled products. Next, clean up the rest of your interior using a solution comprised of baking soda and vinegar – these natural odour absorbers lift stains as it deodorises.

PREVENTION MEASURES

Rather than doing a whole fridge clean out, spreading a thin layer of baking soda, coffee grounds or oats on a baking sheet and leave it in the fridge overnight can help get rid of smells.

Blockage in the sink

Faced with a blockage issue? It's probably caused by food residue. To fix it before foul odour overtakes the kitchen, pour a cup of baking soda mixed in with lemon juice and let it stay in the sink for about 15 minutes. After that, add a cup of white vinegar and wait for bubbles to appear before flushing the affected sink with boiling hot water.

PREVENTION MEASURES

Using a sink strainer can stop food residue from clogging up the drain.

Greasy surfaces

Heavy cooking produces a lot of grease and grime which coats the walls and cabinetry. To get your splatters removed, simply mix one part white vinegar with one part hot water. Next, use a spray bottle to apply the solution and let it set before wiping away with a clean rag.

PREVENTION MEASURES

Installing a kitchen hood can remove airborne grease, fumes, heat and steam. However, with its inclusion comes added maintenance.

Poor lighting

If your kitchen is enclosed and doesn't have sufficient light, opt for brighter LED strips. Recessed spotlights below your top-hung cabinets can provide additional task lighting during food preparation too.

PREVENTION MEASURES

For added convenience, install smart lights within the carpentry – these can be controlled via phone or voice command to create a brighter setting.

Damaged cabinetry

Put through constant use, the screws of your cabinets may get loose. When this happens, it's best to bring in a professional carpenter to get it fixed. Meanwhile, do not fill the drawers with excess weight as it can cause them to sag.

PREVENTION MEASURES

Clean the kitchen hardware with a damp cloth dipped in soapy water and make sure to lubricate the hinges with oil frequently. You could also look into soft-closing cabinets or bumper stick-ons to minimise damage caused by repeated slamming.

Insufficient counter space

Keeping the counter clutter-free is one obvious solution for more prep space. Alternatively, take a leaf out of your extendable dining table by incorporating a pull-out. This addition also doubles as a nifty breakfast nook.

PREVENTION MEASURES

Aside from keeping your kitchen appliances within closed cabinets, mount your pans, pots and other kitchen essentials on the backsplash.



KITCHEN HEAVYWEIGHTS

Complement your kitchen kit with De Dietrich's top-of-the-line combi-steam oven and induction hob.

There are many cooking methods, but steaming is inarguably the way to healthier meals, as are steam ovens, which maintain the nutrients in your food without compromising taste. De Dietrich's combi-steam pyrolytic oven DKR7580X marries the power of age-old steam cooking techniques and advanced appliance design to deliver a streamlined experience fit for gourmet chefs.

Standing at a compact size of 45-cm large, the DKR7580X boasts an impressive 40-litre capacity and three shelf levels for even more efficient cooking without taking up much room. Precise heat controls lower the barrier of entry for newer cooks, as do four versatile

cooking modes: Expert, Cooking Guide, Combined Steam and Expert Steam.

The oven features an electronic touch panel and knob controls with an LCD digit display for easy navigation at a glance. Its Expert mode offers 11 distinctive functions, including a "Bread" mode for the fluffiest bakes.

De Dietrich's pyrolytic function, which decimates residual oil and grease buildup at 500 degrees celsius, leaves nothing but ashes behind for simple cleanups. The process is relatively safe, too, thanks to the oven's four-layer glass door that ensures it stays cool to the touch.



Modern and mighty, De Dietrich's DPI7360X 2-zone Domino Induction Hob is packed with powerful features at a size that's great for smaller kitchens. The hob offers a whopping 19 power levels, including a Boost function that maximises power for reduced cooking time.

It also has Quick Access to various heat settings and smart Recall to replicate your last cooking session settings. These functions are easily accessible with intelligent touch controls. At the same time, De Dietrich's 10 safety features offer peace of mind while you cook.

SETTING UP an energy efficient kitchen and service yard

CHANGING THE WAY YOU CONSUME ENERGY IN THESE AREAS CAN REDUCE YOUR ENERGY BILLS.

It should come as no surprise, but the biggest energy guzzlers can be found in the kitchen or service yard with the fridge, freezer and washer/dryer being the biggest culprits. That said, having a multitude of appliances certainly doesn't help either.

And with hiking energy bills, it pays to look into improving the performance of these machines and introducing changes to make your spaces more efficient.

Watching the wash

It's a common misconception, but underloading your washing machine does not make it any more energy efficient. In fact, washing one large load at a higher setting consumes less energy than washing two loads on a low or medium setting.

Furthermore, 90 per cent of a washing machine's energy is consumed to heat the water. Washing your clothes at a temperature of 30 to 40 degrees Celsius can save significant amount of money on your energy bill.

TIP A front load machine typically consumes less electricity and water compared to its top load counterparts.



Downsize your refrigerator

The bigger your fridge is, the more energy it consumes so downsize if needed. If you have an older model, check the door seal frequently to ensure that it is in a good condition – the more cool air escapes, the harder your fridge has to work.

Remember to check the energy label as you shop. The higher the number of ticks that a fridge has, the more efficient it is.

TIP Not only are top freezer fridges the most common style on the market, they're usually the most energy-efficient models.

Appliance awareness

The modern day kitchen is filled with appliances that use "phantom loads" of energy. What this means is that the appliances are still consuming energy even while they're on standby. The best way to save energy is to turn them off at the source: at the power sockets.

Alternatively, you can use smart plugs to power these energy guzzlers and program them to make them more efficient from anywhere using your smart devices.

TIP With the help of a kilowatt metre, you can check to gauge the energy usage of an appliance when the device is on standby.



Stove service

Using the wrong-sized pan on your stove wastes heat produced by the burner on electric cooktops. Therefore, the pans you use should match the size of your cooking ring.

Burner efficiency is also reduced dramatically when burner pans are blackened from heavy use. To keep it in pristine condition and prevent build-up, you'll need to clean it regularly with mild dish soap and water.

TIP Induction cooktops are the most energy efficient compared to its gas and electric-coil counterparts, although they're incompatible with round-bottomed pans like a wok.

SERVICE YARD solutions

WASHERS, DRYERS, AND EVERYTHING YOU NEED TO
MAKE YOUR SERVICE YARD MORE FUNCTIONAL.



Prevent laundry from piling up by running small loads on the daily with LG's TWINWash™ Mini, the perfect solution for any small service yard.



Compact cleaner

In general, service yards are small and don't leave a lot of legroom for separate bulky washers and dryers. This is what makes **LG's TWINWash™ Mini** a great complement. Only 36.5cm in height, this compact machine can just about fit into the tight space under other LG front loaders.

Convenient size aside, there are plenty of other features to love – there's a Smart Diagnosis™ programme that effectively troubleshoots any issues during your wash cycle, plus a slim inverter DD that offers precise control and a delicate wash for essentials and baby wear.



With innovative ActiveCare technology, Ariston's Heat Pump Dryer gets rid of creases plus bacteria and, most importantly, prevents your garments from wearing out.

Gentle care

The more you wash and dry your garments, the more stress you put the fibres through. This often causes your clothes to lose their structural integrity. Rather than shop for wardrobe replacements in the short term, the **Ariston RNHP9012**, 9kg Heat Pump Dryer offers a more permanent answer. With its innovative ActiveCare Technology, an anti-stress drum movement and precise temperature control, it reduces up to 40 per cent of fabric wear out, keeping your clothes looking their best for longer.

Parents will be glad to know that the delicate drying cycle works for cleaning and drying cuddly toys as well. The low temperatures and a soft mechanical action maintain the original look and shine of fur and other plush fabrics. Plus, the dryer features an Anti-Allergy cycle that removes 99.9 per cent of dust mites for your family to breathe and feel better.

Of course, it too comes with a crease care option that de-wrinkles even the most stubborn of textiles with no heat. Available as a pre-set function before you start your wash, you'll come back to crease-free clothing that only needs gentle ironing!

All-in-one

From fretting over your delicates to sorting through different fabrics, doing laundry seems like a never-ending chore. That said, it's one that can be simplified with the help of **Samsung's** innovative **QuickDrive™ 12kg Washer and Dryer**.

Designed with your convenience in mind, the machine has four built-in sensors that does all the thinking for you, using only the optimum amount of water and detergent you need to get a perfect wash.

Homemakers will also appreciate the larger capacity that allows up to 30 trousers, 34 shirts or even a large comforter to be thoroughly cleaned in one sitting. Other practical features include its Q-Bubble™ technology that reduces washing time by up to 50 per cent, and an option for a steam wash to sanitise your clothes for peace of mind.



Thanks to four built-in AI sensors, Samsung's QuickDrive™ determines the optimum amount of water and detergent automatically for the best cleaning power in 39 minutes.

Our Products
are built with
great love, care
and attention
to detail.

新加坡金字品牌獎
Singapore
Prestige
Brand Award 10
Winner SPSA - Heritage Brands



DALTON
STORAGE WATER HEATER



KINGSTON
INSTANT WATER HEATER



Giving the best we can through
knowledge and understanding
707.com.sg



LET HEAT FLOW

A warm shower after a long day is an easily afforded luxury with the right water heater. All it takes is deciding what works best for your home.

Instant heaters are suitable for compact spaces and are highly energy efficient. The 707 Kingston packs a punch with its Inverter DC Booster Pump, which, as its name suggests, helps boost low water pressure. What's also great about this heater is its safety system, thoughtfully constructed with smart features for your peace of mind. These include an Earth Leakage Sensing Device, which shuts off the power supply upon detecting current leakage, and double-safety anti-scalding protection to prevent burns.

Another standout feature is its Stepless Power Selector, which allows precise control over the water temperature. Plus, the heating element is encased in durable copper, an element highly conducive to heat, for reliable and lasting performance.



Paired with its 11-inch-wide HydroSpa Ace Rain Shower Set, an unconventional feature for instant water heaters, the 707 Kingston promises a truly relaxing shower experience from start to finish.

Larger households can opt for storage water heaters. The Dalton is an excellent choice with its 15-litre and 25-litre offerings. Beneath its modest exterior is a reliable



heating unit equipped with smart functions to increase heat efficiency and energy savings. Durability is a given, thanks to the a Blue Enamel coated tank and heating elements.

Plus, its compact design enables even more space efficiency for easy installation and maintenance, a bonus for snug dwellings.

Both the 707 Kingston and Dalton come with 5 and 10 year warranties, respectively, as well as 2 year warranties for servicing and spare parts.

Cook smart

If you're struggling with the gas stove and its inconsistent cooking temperature, **Whirlpool's Induction Hob ACM808** is what you need.

Whirlpool's FlexiCook system automatically and continuously senses your pan, providing consistent heating even as you move your pan across the flexible cooking zone.

What's more the Eco Booster function saves you up to 10 per cent energy, analysing the exact power, time and energy required for your task. You have total control over the hob's power level too – simply adjust the Power Management function to avoid the risk of overloading your home's energy supply.

Whirlpool's Induction Hob ACM808 comes with four cooking zones that automatically and continuously senses pans of all sizes, giving you greater flexibility across the board.

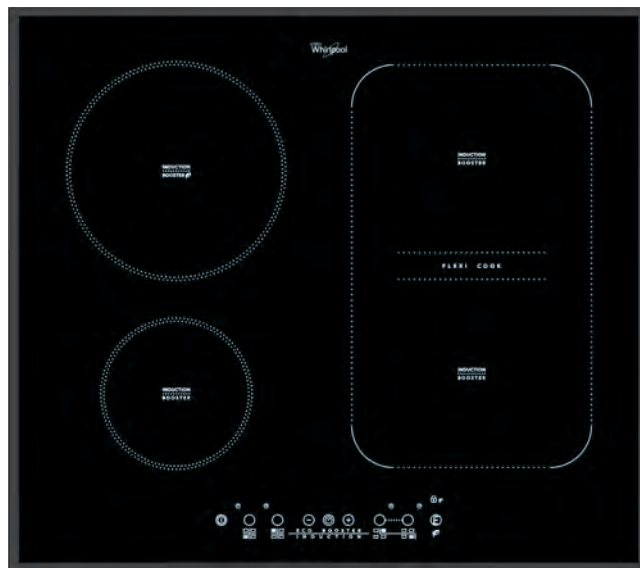

Methods to maximise your small yard

1 LOOK INTO LAUNDRY SYSTEMS

It always pays to think about your ceilings as an extension of your home. Rather than rely on clothing racks that will make the service yard feel even more claustrophobic, installing a mini laundry system can get you more mileage. Not only do they usually feature a larger load capacity, but some also come with built-in solar heaters that dry your clothes quicker without the help of a dryer.



2 EXTEND YOUR KITCHEN PREP SPACE

Similarly, part of building an efficient home involves using your service yard as an extended part of your kitchen. Building in a work surface can give you more prep space when needed, and leaves more room on the side for storing your washer and dryer.

3 EXPAND THE SPACE VISUALLY

To make for a smoother transition, sticking to a type of flooring and extending it from the kitchen to the adjacent service yard will make the two spaces look one and the same. Using glass doors and windows in tandem can help to brighten and create the illusion of a bigger space too.

Tefal®

PRO EXPRESS ULTIMATE

PROFESSIONAL TECHNOLOGY



Make your ironing twice as fast*
with a POWERFUL Steam Generator

MADE IN FRANCE

UP TO **7.7** Bars

UP TO **155** g/min
STEAM OUTPUT

UP TO **570** g/min
STEAM BOOST

Pro Express Ultimate
GV9566 Steam Generator

*vs a basic steam iron

f TefalSingapore | www.tefal.com.sg

VERSATILE WONDERS

Introducing Tefal's latest countertop appliances that'll turn the kitchen into your favourite (and most efficient) room.

Where home cooking is concerned, your tools are just as essential as the recipe. But investing in the right ones can be tricky in compact kitchens. Get the most out of your cooking space with versatile appliances like the Tefal RK7621 Rice Express Induction and BL967 Dynamix Cook 2-in-1 High Speed Cooking Blender. Both make room for a myriad of hearty, fulfilling dishes that require very little preparation.

Blenders aren't just for smoothies. The BL967 Dynamix Cook 2-in-1 High Speed Cooking Blender is a truly versatile workhorse. It features fast-heating technology reaching up to 100 degrees Celsius to cook ingredients while blending with powerful razor-sharp Powelix blades that reach 35,000 rotations per minute at maximum speed. Be it creamy soups, thick porridges or a conventional cup of juice, satisfy your



cravings with the BL967's 10 hot and cold auto programme.

Maintenance is easy with two auto-clean functions: Deep & Quick to kill up to 99.99 per cent bacteria and Quick Clean to rinse its 1.75 litre capacity glass in less than a minute.

Get perfectly fluffy rice each time, no matter the grain, with the Tefal RK7621 Rice Express Induction Cooker. Thanks to 12 versatile cooking programmes that

deliver delicious results on a wide variety of rice dishes, food preparation is foolproof.



And with Tefal-exclusive Xpress Cook technology, waiting time is cut in half – perfect for users who prefer spending less time on cooking.

Living GREEN

HOW TO SET UP A RECYCLING SYSTEM THAT'S EASY TO COMMIT TO, EVEN FOR BUSY SCHEDULES.

From sorting disposables to tracking down the blue recycling bin or chutes around the block, recycling in Singapore may be a little inconvenient sometimes. Still, there are steps to make the process easier, and with a little dedication, these efforts will start to pay off. Who knows? You might even successfully lead a zero-waste lifestyle one day!



Trash talk

What you consume the most will have a direct impact on the type and size of the recycling bins you require. If your family orders a lot of takeout and drinks, you'll need bins to separate the paper, plastic and metal cans. They should be of a larger size if you need the increased capacity.

Create convenience

The ideal home recycling centre should be a two-part system to promote convenience – the first for everyday disposal and the other for storage. The 'everyday' bin should be placed where you generate the most waste, and for many that would be the kitchen. It should be kept accessible where possible for it to serve as both a reminder and for added convenience.

TIP Remember, you'll need to pick up a bin for each recycling category you have, but if you're short on space, consider getting wall-mounted containers or sturdy shopping bags that you can tuck into a cabinet.



Start composting

For the uninitiated, composting is a process that converts your food waste into plant fertiliser. It's incredibly useful in reducing your environmental footprint by cutting down on the need for food incineration, and also in providing you with a nutritional fertiliser for your plants. Bokashi composting and vermicomposting are the two methods most suited for high-rise homes.

Store it smartly

Can't make time to clear out the bins all the time? Move them into a temporary storage spot like the service yard until you make the trip to drop off the contents in the chute or the blue bin down the block.



Note guidelines

It goes without saying that your containers should be labelled so that your family members and guests will know how to sort their waste. At the end of the day, your recycling bins should not contain any food, liquid waste, tissue, ceramics, light bulbs, batteries or bulky items.



BOKASHI COMPOSTING

Bacteria is introduced to break down food waste inside these airtight bins. The waste is left there for a few days, and you'll only need to drain off the compost juice.



VERMICOMPOSTING

Vermicomposting makes use of black soldier fly (BSF) larvae to break down the food waste. In addition to the compost, the larvae's 'poo' can be steeped in water to produce a tea that's nutritious for your plants.



OLED+ THE DIFFERENCE IS REAL

Hot on the heels of its award-winning OLED+ TV models, Philips is raising the bar with the OLED+935 series 4KUHD Android TV – Bowers & Wilkins sound with Ambilight 4-sided.



Quality home cinemas aren't just a pipe dream with the Philips OLED+935 TV, which delivers the ultimate theatre-level audiovisual experience – right from the comforts of your living room.

Thanks to three powerful features, the 2020 flagship model is a standout amongst the sea of fantastic OLEDs on the market. And despite its bold list of equipment, the Philips OLED+935 boasts a sleek design with lavish details in polished chrome. Its high-end speakers even come clad in premium fabric for added luxury.

AI-enhanced, Hyper-real Display

Beyond its crisp 4K Ultra High-Definition (UHD) OLED display, the Singapore 2021

flagship model now includes an in-house developed Artificial Intelligence (AI) functionality, which leverages neural networking and machine learning to balance visual output for more realistic imagery. Paired with its new P5 AI+ processor, the OLED+935 continues to be one of the very few sets to support Dolby Vision and HDR10+ HDR formats at optimum performance levels.

High-Quality, Immersive Audio

Philips' continued partnership with Bowers & Wilkins has ensured a revolutionary 3.1.2 sound system, UP-firing speaker for Dolby Atmos Elevation and integrated soundboard for true hi-fi TV audio. Audiophiles will appreciate the



option of a separate subwoofer for bass extensions if required.

Smart Ambilight Lighting

Then, there's its four-sided Ambilight lighting system, with intelligent LEDs that

respond to on-screen action for an even more immersive experience. Both 55- and 65-inch models come equipped with a new wellness feature to the Ambilight system, with the Sunrise function now joined by a new Ambilight Sleep mode.

The OLED+935 is loaded with the 9.0 version of Android TV, enabling intuitive and seamless navigation from start to finish. Besides having quick access to live TV channels and on-demand apps such as Netflix and Disney+ via the start menu, users can use the voice-controlled Google Assistant, Alexa or Philips' upgraded Bluetooth-based remote control to toggle through its many intelligent functions.

mindful MATTRESSES

SELECTING THE RIGHT MATTRESS FOR YOUR BEDROOM IS MADE EASIER WITH OUR GUIDE.

Considering how much time we spend in bed, a good mattress is imperative for quality sleep (we spend over 100 days a year asleep). But not all mattresses (and sleeping habits) are made equal, and there's much to consider before taking the plunge. Check out Gain City Megastore @ Sungei Kadut, where there's a whole level of bedding and mattress accessories and helpful staff to assist you in finding the right fit.



CONSIDER:

Your sleeping position

There are three main types of sleeping positions: side, tummy and back, and there are different mattress requirements for each. Side sleepers should go for softer memory foam mattresses with deep body contouring and pressure relief as they tend to exert more force on their joints. In comparison, a medium to firm mattress is typically better for tummy and back sleepers for better spinal support.

CONSIDER:

Partner preferences

Compromise is key for those who share a bed with a partner or child, especially for restless sleepers who toss and turn all night. Factors like weight, sleep preferences and more play a part. But when in doubt, pick medium-firm innerspring mattresses with pocketed coils, memory foam or latex for better motion isolation.



1 ★★★★★★
World's No.1
OLED TV Brand



LIGHT UP YOUR WORLD
SELF-LIT PIXELS HAVE EVOLVED*

LG OLED_{evo}

powered by **ThinQ AI**

*Source - Omdia. Unit shipments, 2013-2020. Results are not an endorsement of LG Electronics. Any reliance on these results is at the third-party's own risk.

NEXT-GENERATION DISPLAY

**LG is paving the path for unparalleled,
immersive home entertainment experiences.**

With the world spending more time indoors than any other generation, more are upgrading their home entertainment set-ups to make staying in more exciting. Transform your experience with the LG OLED G1 "Gallery" series, which feature the tech giant's latest 4K OLED Evo panels for the ultimate viewing pleasure.

Breathtaking Visuals

Unique to LG's offerings thus far, the G1 series' Evo panels are a major evolution for OLED. In case you didn't know, OLED comprises millions of self-lit pixels, allowing even more spectacular image quality.

Inspired by art, the G1 Series elevates the extreme realism capabilities already offered by LG OLED TVs in a stunningly sleek

package that complements your interior design needs.

Paired with a powerful Alpha 9 Gen 4 processor (which uses deep-learning algorithms to analyse and optimise content), the next-generation OLED panel tunes and enhances everything displayed, resulting in brighter and sharper images.

Beyond superior picture quality, the G1 Series takes immersive home entertainment to the next level, supporting Dolby Vision IQ, Dolby Atmos®, HDR10 PRO and Filmmaker Mode™. Dolby Vision IQ intelligently adjusts picture settings based on genre and ambient surroundings. At the same time, Dolby Atmos® provides multi-dimensional surround sound for breathtaking



cinematic results. Other LG innovations like the HDR10 Pro and Filmmaker mode amp up clarity and detail while downplaying motion smoothing, delivering content just as its creators intended.

Easy on the Eyes

Indulge in movie marathons safely with the Eye Comfort Display function. LG OLED TVs are officially certified as low-blue light, flicker-free, and discomfort glare-free displays. The pioneering feature is also why LG's OLED TVs are the first panels to receive the EyeSafe® certification developed by TÜV-Eyesafe®.



CONSIDER:

Your body temperature

Running hot while sleeping can affect the onset and quality of slumber. Instead of ditching your blankets or turning up the air conditioner, opt for a mattress with a sprung layer, which allows improved airflow between coils for better heat regulation.



CONSIDER:

What your back needs

Suffering from back pain? Opt for medium to firm, latex or memory foam mattresses with high spine alignment support and pressure relief to alleviate aches and pains.

The Right Fit

Homeowners with smaller bedrooms may face issues when it comes to selecting the right-size mattress for the space. Here are some tips to help free up valuable space without downsizing your bed.



1 GET A BED FRAME WITH BUILT-IN STORAGE

From ottoman beds to frames with pull-out drawers, opt for designs that give you plenty of storage without taking up more floor space.

2 USE THE HEIGHT OF YOUR BEDROOM

Thinking tall frees up valuable floor space. Whether it's bunk beds or wall shelving, use the height of your bedroom to your advantage.

3 SELECT THE RIGHT FURNITURE

Ditch bulky furniture for versatile pieces that offer more storage space while taking up less bedroom real estate. Mounted end tables or headboards that offer side shelves, for example, are great space savers.

4 OPT TO SLIDE

Doors are often overlooked in tight quarters. Instead of a hinged door that swings outwards, free up more space with sliding or pocket door designs for your cabinets, wardrobe and adjoining bathroom.

FOREST

MaxCoil

FORREST™ Botany Tencel Where Nature Meets Comfort

Create a sanctuary of long-lasting comfort
with MaxCoil's New FORREST™
Botany Tencel Mattress Collection

Exclusive Giveaway
for City Living readers
Win A Pair of MaxCoil
Dual Feel Luxe Pillows
Worth \$358

Scan QR code
to participate



Available only at Gain City Sungei Kadut Level 4

BEST NIGHT'S SLEEP

**Bid goodbye to body aches and hello to deep, restful slumber
with MaxCoil's latest mattresses**

A good mattress is one of the most important purchases for your home and essential for a good night's rest. MaxCoil's Tenesea and Tenedere mattresses are great selections that offer superb comfort and support. Both feature MaxCoil's Forrest™ Botany TENCEL™, a soft fibre of botanic origin with long-lasting softness and excellent breathability properties that help the body stay cool and comfortable, even during Singapore's warmer nights. Tencel fibres are derived from sustainable wood sources and are harvested from certified and controlled sources to bring gentle, long-lasting comfort.



The MaxCoil Tenedere is a 13" pocketed spring mattress with a pillow top design and medium soft comfort feel. Sporting a layered mix of premium memory foam, high-density soft foam and medium-firm foam, this mattress is able to adapt to users' unique body contours for

that cushioned body-hugging feel while also providing ample support from top-to-toe. Light sleepers will appreciate the Tenedere's motion absorption, which stops motion transfer from one side of the bed to the other – meaning fewer disturbances from your partner's movements during the night.

The MaxCoil Tenesea 14" pocketed spring mattress features Belgium natural latex form with a pillow top design and medium firm comfort feel. Combined with layers of responsive high-density foam and a motion-absorbent pocketed spring system, this mattress helps to promote natural spine alignment and offers excellent relief for pressure points. Both Tenedere and Tenesea mattresses come with Swiss Sanitized® antimicrobial treatment, providing much-needed protection against bacteria, mould and dust mites for peaceful nights of comfortable sleep.

**WIN! MaxCoil is giving away
a pair of Luxe pillows worth \$358.
Scan the QR code to enter!**

SMART SANITARY SOLUTIONS

**DRIVEN BY INNOVATION AND TECH, SANITARY SOLUTIONS SPECIALIST RIGEL
MARKS ITS 30TH YEAR OF EXCELLENCE.**

Founded in 1991, homegrown sanitary solutions specialist Rigel has grown from strength to strength through cutting-edge, smart and environmentally-friendly bathroom solutions.

With astute forecasting of the market's needs, Rigel conceived its first product: a sensor-based auto-flush toilet that used infrared motion-detection technology. Following its success, Rigel soon incorporated this innovative tech into various toilet prototypes and other bathroom products such as faucets and soap dispensers.

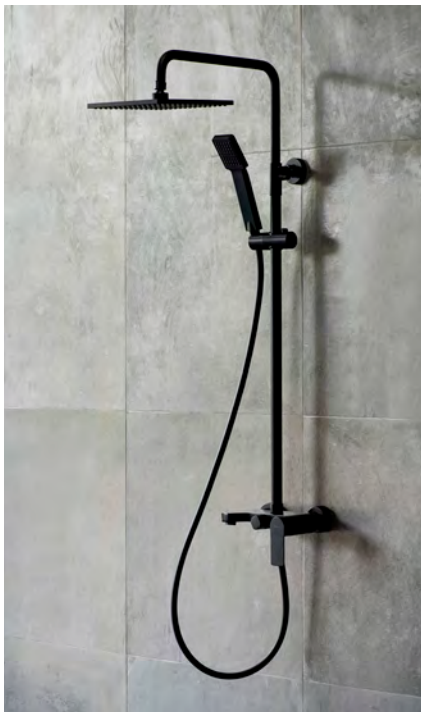

The award-winning brand constantly redefines its tech advancements with green innovation, intelligent technology and clean, sleek and comfortable design. The best part? Homeowners can now build their world-class bathrooms with Rigel's products while enjoying the same industry-leading innovations and quality afforded to commercial projects. Kickstart your bathroom renovation by first checking out Rigel's products, available at Gain City Megastore.

Rigel has developed over 200 new products used in more than 35 countries, including Malaysia, Indonesia, Vietnam and China. Closer to home, Rigel's prominent projects include Singapore Changi Airport, Marina Bay Sands, Singapore National Gallery, Funan Digital Mall and more.

With its emphasis on smart, holistic sanitary solutions that focus on what people and the planet needs, Rigel is the prime choice for well-designed bathrooms.



LUXURY BATHROOM SOLUTIONS

Bring Rigel's world-class bathroom fixtures into your home.

As one of the most personal and private spaces in the home, it only makes sense to have your bathroom be a space you enjoy spending time in. A simple way to achieve that without extensive remodelling is by using thoughtful fixtures that combine function and form. Rigel's award-winning product portfolio is full of tech-driven innovations that'll make a splash while improving your bathroom experience.

Premium Elegance

Homeowners who want to set their bathroom apart can opt for Rigel's Premium Bathroom Collection, which offers true marvels of design and function. Take, for instance, their series of matte-black fittings. It features a range of bathroom fixtures and accessories, from rain shower systems to faucets and basins, all clad in stylish matte black. Most bathrooms are designed with a neutral palette to extend the longevity of the style and design, so black fixtures will work well and become a prominent feature in your bathroom.

Another standout is Rigel's Doux series. Doux, which means "sweet" in French, is an



apt description of the rose gold-hued collection. These fittings instantly add touches of timeless luxury without overwhelming the room.

While daily usage makes wear and tear inevitable, Rigel's fixtures have PVD (physical vapour deposition) finishes to ensure premium wear and corrosion resistance, as well as high durability for years to come.

Flushing Success

The Gallant Series Close Coupled Water Closet is a sleek porcelain throne fit for royalty. It comes kitted out with Rigel's WhirlWash technology, which allows for a high-impact, powerful yet silent flush with as little as three litres of water.

More exciting is the toilet's rimless design, which prevents germ growth and dirt accumulation. It doesn't take much work to keep this toilet clean either, with Rigel's patented PuraGlaze formula that incorporates an advanced hydrophilic formulation to resist odours and unsightly marks and stains from forming on the ceramic surface. After usage, push on its chrome-plated flush and watch it all swirl away – quickly, silently and without a trace.





sleepy SPACES

LOVE NAPPING? HERE'S HOW YOU CAN TURN YOUR HOME INTO ONE FILLED WITH SNOOZE-FRIENDLY SPOTS.

Whether it's snoozing on the sofa or napping in a designated nook, having spots suitable for unwinding and relaxing is the hallmark of a cosy abode. Set up your cosy corners with these easy tips.

Get the right lighting and temperature

Soft, comfortable lighting and cool temperatures are essential for great naps, even if you're getting some shut-eye in the middle of the afternoon. Maximise your midday snooze by keeping the area dark, quiet and slightly cool with room-darkening curtains and dimmable warm lights.

Remove clutter

The positive effects of decluttering extend beyond your physical space. At the very least, being in a clean and organised environment helps reduce stress, leading to more restful sleep. Set aside 10 to 15 minutes a day to put away stray items and invest in better storage solutions for your knickknacks. Check out our guide on page 20 for more organisation tips.

Play with soft textures and textiles

The easiest trick to instantly cosy up any spot is by adding soft textures and textiles. Think plush, oversized cushions, throws and even blankets to make your nap area even more comfortable. These textures are easy to integrate into any home design and make the overall space feel more welcoming and less rigid for guests and household members alike.

Add natural and organic elements

Breathe life into your space with natural elements like indoor plants and wood furniture, promoting feelings of harmony and relaxation. Consider adding some built-in wall alcoves for indoor plants – lavender, orchids and succulents are great for beautifying your space while improving air quality.

Indulge in soothing scents

Certain scents like lavender, lemongrass and ylang-ylang are great for stress relief. Rub one or two drops of essential oil onto your pillow, or begin diffusing the oil an hour or so before snoozing for better nap quality. If you're not a fan of aromatherapy, check out our humidifier and air purifier guide on page 69 for sleep aids to help you rest easier.



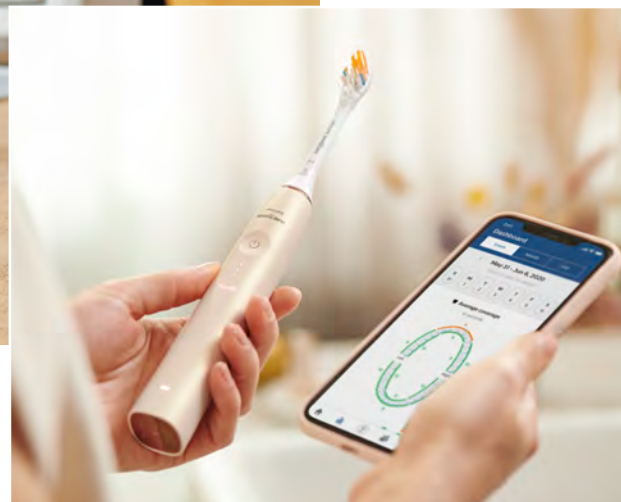

HOME AND HEALTH

Philips' latest products promise more convenience and results for everyday routines.



Investing in hardworking products that do more with less is key to a fuss-free lifestyle. Philips' latest offerings: the Cordless Vacuum 8000 Series Aqua Plus and Sonicare 9900 Prestige, both game-changing products, does precisely that.

Cleans Beyond Dust

Gone are the days of having to do a final wet wipe down of the floors after vacuuming. Not your run-of-the-mill device, Philips' 8000 series Aqua Plus is a versatile, three-in-one appliance that's able to clean different types of messes in one go.

It doesn't matter if it's invisible dirt, stains, crumbs and damp dirt; the Aqua

Plus' unique two-in-one nozzle vacuums and effectively cleans multiple types of dirt all in one fell swoop. Cleanups are made even simpler with its intelligent auto-adjusting nozzle, which features dual suction channels with unique, patented water distribution to maximise performance. Users can even add their favourite detergent into the water tank to remove up to 99 per cent of bacteria.

For light cleaning, the vacuum comes with an additional 360-degree suction nozzle to capture up to 99.7 per cent of dust and dirt in one easy stroke. The LED lights attached to this nozzle illuminates surfaces so users won't miss a spot, even in hard-to-reach areas.

A Smart Digital Display enables effortless control over the vacuum's PowerBlade digital motor and easy tracking of its speed, battery usage and filter cleanliness.

Smart Brushing

Spruce up your pearly whites with the latest Philips Sonicare 9900 Prestige – the Sonicare range's most advanced electrical toothbrush yet. Powered by SenseIQ technology, the 9900 Prestige provides personalised cleaning experiences based on users' brushing styles and duration. It does so via hardworking sensors that

enable the smart device to detect and automatically adjust the intensity of its settings while brushing.

Adding on, the Sonicare 9900 Prestige comes equipped with a premium, all-in-one brush head that allows users to remove plaque and stains and care for gums without needing to switch brushes. Oral hygiene isn't compromised, though. The versatile brush head features long, angled bristles with triangle tips to help remove up to 20 times more plaque. It also provides deep gum cleaning that is up to 15 times more healthy compared to traditional toothbrushes.

Users who love data will appreciate the accompanying Philips Sonicare app. Powered by artificial intelligence, the app works with the Sonicare 9900 Prestige to offer real-time, personalised recommendations and steps for better brushing.





WHAT'S **Cool?**

BREEZY COMFORT

Smart tips to cut air-conditioning energy bills and more.

**LEDVANCE**

LEDVANCE.ASIA

NATURAL LIGHT FOR NATURAL LIFE ILLUMINATING YOUR WORLD, NATURALLY



LEDVANCE TruWave Technology™ mimics the natural daylight spectrum to deliver visually comforting natural daylight. This is achieved by avoiding some of the typical flaws of artificial lighting systems.

HOW CAN TruWave Technology™ BENEFIT YOU?



IMPROVES THE SLEEP / WAKE CYCLE

By mimicking the natural light spectrum



REDUCES EYE STRAIN

By emitting light with less intense blue light



BOOSTS ATTENTION AND ALERTNESS

By providing a balanced blue light



IMPROVES MOOD AND LIFE QUALITY

By creating a welcoming and comfortable light



THE FUTURE IS BRIGHT



One of the world's leading general lighting providers for professionals and end consumers, LEDVANCE leverages its century-long history of crafting lights – and its propensity for intelligent solutions – to redefine lighting in a modern, hyperconnected world. Today, LEDVANCE has a global presence in over 140 countries and offers a wide range of LED luminaires and intelligent lighting products for smart homes and buildings, as well as traditional light sources.

SMART+ Brighter Days

Transform your abode into a high-tech one with LEDVANCE's smart lighting technology. Forget fumbling around in the dark for the light switch – SMART+ allows users to control, dim and personalise lights in an instant using either the LEDVANCE APM SMART+ Wi-Fi app or voice command. The SMART+ range is compatible with many applications, including Alexa, Google Assistant and Siri Shortcut. And with 16 million fascinating colours between warm and cold white light, there's sure to be at least a dozen lighting options for every situation.



Coming soon! Look out for LEDVANCE's new, eco-friendly repackaging that features sparkling black with a pop of the brand's signature orange. Made from 100 per cent recyclable cardboard and 100 per cent plastic-free, these lights are the perfect additions to eco-conscious households.

set up your home FOR CHILLING SUCCESS

YOUR EASY-BREEZY GUIDE TO STAYING COOL INDOORS DURING BLAZING DAYS.



temperatures are soaring, but there are plenty of simple and cost-effective ways to beat Singapore's sweltering heat than simply putting your air-conditioning on full blast. Try incorporating these easy tips for a cooler and more comfortable home.

**SHARP**

Be Original.

Proudly present

iF DESIGN AWARD 2021



SOUNDBAR HOME THEATER SYSTEM
DOLBY ATMOS (8A-C22CX1)

62m² HUMIDIFYING AIR PURIFIER
AIOT APP + PLASMACLUSTER (KI-L80E-T)



500L 4 DOOR FRENCH SERIES
COMING SOON (SJ-VX57ES-DS)



FRONT LOAD WASHER DRYER COMBO
10.5 KG / 7 KG (ES-FW105D7PS)

WINNER'S CIRCLE

Introducing award-winning Sharp home appliances that won the prestigious 2021 iF Design Award, and evergreen favourites.

Touted as one of the world's most prestigious design awards, the iF Design Award recognises outstanding design in nine disciplines and saw almost 10,000 entries in this year's edition. Sharp has swept four awards in the "Product" category, including the ES-FW105D7PS front-load washer and KI-L80E-T Humidifying Air Purifier. Each product is designed and conceptualised to give people a sense of security and comfort and make lives more comfortable.

KI-L80E-T Humidifying Air Purifier

The KI-L80E-T features unique Plasmacluster ion technology that purifies the air and advanced Internet of Things technology that enables smart humidification and intuitive usability in a seamless design. Be



it smokey cigarettes, dust mite allergens or diesel exhaust, this versatile trooper eliminates it all.

Pro-Flex Washing Machine

This reliable front load washer-dryer combination comes equipped with Plasmacluster Ion Technology to remove bacteria, mould and odours, as well as a Steam Care function that ensures 99.9 per cent removal of allergens and germs. Users can also use the Dry AirWash feature for harder-to-clean items such as bedding or thicker clothing. Toggle through the Pro-Flex's washer-dryer settings easily using its Intuitive Control Panel for greater laundry efficiency.



8A-C22CX1 Sound Bar Home Theater System

Expect immersive sound quality with the 8A-C22CX1 – the soundbar is equipped with OPSODIS Technology to enable high definition 3D sound reproduction and is Dolby Atmos® compatible for surround sound. It also comes with a three way-10 speaker system with six built-in digital amplifiers, with seven preset modes so users can select what best suits the original sound source.

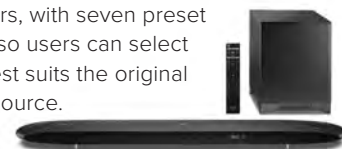

2nd Gen AQUOS TV

The perfect addition to any home theatre, Sharp's 2nd Gen AQUOS TV features 8K resolution and AI Upconvert, as well as a Z2 Revelation processor that upgrades your viewing experience in overwhelming clarity. Soundwise, it is equipped with Eilex Prism™ to capture and correct changes in acoustic power for 360-degree immersive sound.



Good ventilation

Feeling stuffy at home? Good ventilation is key. One way to ensure proper ventilation is to keep your doors and windows open. This encourages cross-ventilation to occur, which lets the cool air in and keeps the hot air out, thus ensuring a constant airflow throughout your home that will help to bring down the overall temperature.



Keep out sunlight

A lot of warmth comes in the form of sunlight, so you might want to install some curtains and blinds to keep those rays at bay. Blackout curtains are especially useful in combating heat, as it's made of tightly-woven fabric that's thick enough to block almost 100 per cent of sunlight from entering the room. Aside from curtains, window films are also great for UV protection – and it comes with the added benefit of shielding your furniture from sun damage as well!





COOLER COMFORTS

As one of the world's manufacturing heavyweights, Mitsubishi Heavy Industries has come a long way since its founding in 1884.



Mitsubishi Heavy Industries' (MHI) focus on pioneering new manufacturing approaches has led to a diversified and expansive portfolio across sectors, from land and sea to sky and space. The air conditioner market is but one of them. Headquartered in Japan, the global conglomerate has four major business domains: Energy & Environment, Machinery, Equipment & System, Transportation and Defence & Space.

Beyond the sale of air-conditioners for residential and commercial usage, the organisation has contributed to Singapore's built landscape with commercial projects like the Marina Bay Sands District Cooling Project and Waste-to-Energy Plant, LRT projects and more. MHI synergises its businesses by integrating technical expertise with its comprehensive range of energy-efficient air conditioners for residential and commercial use.

Performance-Driven Air Conditioners

MHI carries room air conditioners (RAC), which suit both HDB and private estates. It boasts top-of-the-line features such as Jet Air Technology, which uses the same aerodynamic analysis tech in developing jet engines to enhance airflow. Motion sensor functions detect human

movement and make auto adjustments to room temperature accordingly.

Keeping cool

MHI's latest SCM80YT-S air conditioner series is created specifically for the Singaporean market. Featuring a capacity

range engineered to match the typical size of Singaporean residences, the SCM80YT-S comprises an 8.0kW split-system for System 3 and 4 connectivity, suitable for HDB dwellings. Also, the series aims to achieve the highest standards in local energy savings while keeping noise output relatively low.

A newly-minted wall-mounted unit complements the outdoor air-con unit for residential use. The SRK35ZS-W, a 3.5kW indoor full compressor unit, comes equipped with 3D auto technology, the fuzzy auto mode for automatic, energy-saving operations, and more. MHI steps towards smart tech by enabling its latest air-con models with remote control access using a wireless LAN interface.



CEILING CASSETTE-4 WAY-FDT



SCM80YT-S

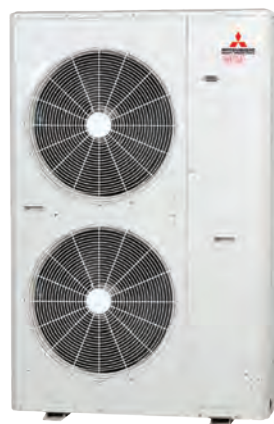

KX-MICRO



KXZ



Add in a fan (or two)

You might want to consider installing ceiling fans in key communal areas such as the living and dining rooms. Compared to standing fans, ceiling fans do a much better job at promoting air circulation without having to occupy a ton of floor space, which also means there's lesser obstruction to airflow. Another trick is to reverse the direction of the fan blades. Setting it to anti-clockwise creates a downward airflow for a windy, chilling effect.

Bring in some greenery

An all-natural way to bring in the fresh air? Fill your home with indoor plants. The science behind it is simple: photosynthesis. Plants absorb greenhouse gases from the atmosphere, and release oxygen back into your surroundings. Not only does it help to improve your quality of air, it's also said to be capable of purifying the air from harmful toxins. For those without a green thumb, the spider plant, snake plant, and money tree plant are some good starter options.





COOLING TITANS

Beat the heat and enjoy advanced indoor air quality with
Mitsubishi Electric Starmex R32 FP Series and Plasma Quad Connect.



More Energy Savings

Electrical devices consume energy even while not in use, and air conditioners are no different. The FP series comes equipped with a Low Standby Power feature which reduces wasted power consumption by 90 per cent. Furthermore, the series which has obtained five ticks on NEA's energy-efficient rating system, also adopts a lower global warming potential (GWP) refrigerant R32, that makes it easier for reuse and recycle while reducing carbon emissions. A R32 system uses 15 to 20 per cent lesser refrigerants, deliver a lower density and higher efficiency that could potentially save approximately 10 per cent of electricity bills.



Dual Barrier Coating

Air conditioners are highly susceptible to dirt, and regular cleaning is essential to ensure fresh and clean air and improve energy efficiency in the long run. Mitsubishi Electric's patented dual barrier coating reduces dirt and grease from sticking on the interior of the indoor unit delivering comfortable clean air.

Plasma Quad Connect

Want even better indoor air quality? Opt for Mitsubishi Electric's Plasma Quad Connect, a bolt-on device that provides air-con units access to the advanced Plasma Quad Plus filtration system. It utilises electric discharge to catch and neutralise microscopically small particles like PM2.5 while removing bacteria, allergens, mould and even approximately 99.8 per cent of the SARS-CoV-2 virus.

Zero-cost Hacks to Maximise Your A/C Efficiency

KEEP YOUR COOL WHEN THE BILLS COME DUE WITH THESE ENERGY-SAVING IDEAS!

1

SET YOUR THERMOSTAT

You don't have to keep your room icy-cold at all times; doing away with a few degrees can help to save costs significantly. We recommend increasing your thermostat to a comfortable temperature that works for your family, so that it can run uninterrupted for longer periods without having to adjust it frequently. Constantly fiddling around with the thermostat disrupts your on and off cycles, which may end up dampening your unit's efficiency levels. Likewise, you can also consider getting a programmable thermostat for optimal temperature control.

TIP! When choosing an air conditioner, look out for energy-efficient features that can help to cut down on power consumption. For instance, a built-in timer that allows you to set different temperatures at specific time periods to optimise usage. A lot of models also come with smart capabilities that let you control the temperature from your phone, so you won't ever have to worry about forgetting to turn off your aircon.



2

FIX AIR LEAKS

Your air conditioner needs to work extra hard when there's air leakage, and an overworked system will undoubtedly result in higher utility spendings. To improve your energy efficiency, make sure to plug up all those unintended gaps and cracks to prevent conditioned air from escaping your home. Some of the common culprits include under-the-door drafts, around the windows, and even on recessed lights.



3

KEEP CURTAINS DRAWN

Shut out the sun by keeping your curtains drawn during the day. By covering up your windows, you can reduce the amount of heat coming into your house. This helps to minimise the amount of work that your system has to do. It's a good idea to close your curtains or blinds before leaving for work to ensure that your home stays cool, even on the warmest days.



TOSHIBA

榫卯
職人の魂
Tenon and Mortise

THE GREATWAVES™

SMARTWAVES
MEMORY
QUICK 12"
WASH 45"
Wool
ECO WASH
ANTI-ALLERGY

COTTON
GREATWAVES™
MIX
BEDLINEN
SPIN ONLY
DRUM CLEAN

TEMP.
SPEED
EXTRA RINSE
STEAM



ULTRA-CLEAN WASH

Toshiba's BK Series Washers embrace both form and function for more enjoyable laundry days.

When it comes to conquering mountain loads of laundry, Toshiba's BK Series Washers are top contenders with unique features that elevate the range's superior stain-fighting abilities.

One such feature is the Ultra Fine Bubble washing technology, which combines high-frequency vibrations and nano-sized bubbles to flush and dissolve stubborn stains and dirt from deep within the fabric.

The removal of sebum buildup, which causes clothing to turn yellow, is enhanced by 18 per cent. In comparison, any lingering bacteria or residue is reduced by 15 per cent for

fresh and longer-lasting fabric.

Another nifty function is Steam Wash. Upon activation, the washing machine uses steam scalding to sterilise and deodorise fabric by 99.99 per cent. Users will also enjoy Toshiba's unique "THE GREATWAVES" technology. It combines three powerful waves: Flush Wave, Cold Wash and Colour Alive, to ensure each load of laundry yields more significant savings and enhanced colour protection.

Finding the right fit for your family's laundry needs is easy, too, as the BK range offers load capacities of 8.5, 9.5 & 10.5kg.

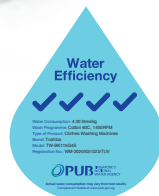



4 #4 TURN OFF HEATY APPLIANCES

When not in use, switch off heat-producing appliances such as the television, dishwasher, oven and vacuum cleaner. These household products generate a significant amount of heat, which forces your air conditioner to work even harder to compensate for this surge of warmth. To lower your overall energy consumption, consider doing your tasks in the evening hours when temperatures are cooler and avoid running multiple appliances at the same time.

TIP! Don't forget to have your air conditioner professionally serviced at least twice a year! Proper maintenance will keep your system in tip-top shape and ensure that it performs at maximum efficiency. Gain City provides regular servicing, as well as maintenance and repair works at competitive prices. Book your service appointment with Gain City now!



5 KEEP YOUR FILTERS CLEAN

It's easy for dirt and debris to build up within the unit, which may clog up your filters and reduce the airflow, making it more difficult for your air conditioner to work efficiently. Thus, it's important to make sure that your filters are cleaned on a regular basis to keep your system running smoothly. Every two to three weeks, remove the filter and gently wash it out with a mild soap solution, then let it dry completely before reinstalling it. If you don't have time for it, you can always leave it up to the professionals at Gain City to do the work for you instead! Visit www.gaincity.com/airconservice or call 6222 1212 to find out more.



Hot #WFH tips!

1

CREATE A DEDICATED COOLING ZONE.

You don't necessarily need to cool your entire home when you're working at the same spot all day. Just leave the air-con on in your home office or workspace, and keep the rest of your flat at a normal temperature.

2

INVEST IN A DEHUMIDIFIER.

For days when you're feeling hot and sticky, a dehumidifier will come in handy in regulating humidity levels for a more comfortable work environment. Bonus? You can even use the leftover water to water your plants!



3

SWITCH OUT INCANDESCENT BULBS.

While it's one of the cheapest options, incandescent bulbs tend to give off more heat than actual light. Instead, opt for LED lights which consume less energy and last a lot longer too.

4

MAKE USE OF FANS.

Don't have a ceiling fan in your workspace? A portable standing fan or a small desk fan works just as well in improving the comfort factor. Just remember to turn it off when you leave the room to prevent wasting energy!

EASY & breezy

LOOK OUT FOR THESE COMMON MISTAKES TO ENJOY AN AIR-CON SYSTEM THAT RUNS STRONG FOR YEARS.



Experts recommend comprehensive air-con inspections and servicing at least once a year – not forgetting the routine checks that homeowners should conduct in-between. But on most days, our air conditioners function like clockwork, making it easy to fall behind on maintenance. And in sunny, humid Singapore, ensuring that air-con systems stay in tip-top condition (no pun intended) is crucial to beat warm weather and cool off on energy consumption.

How we interact with our air-cons do affect their efficiency and performance. Ensure your cooling system performs at its best capacity for longer by avoiding these common mistakes.

MISTAKE:

Buying an oversized (or undersized) air conditioner

Contrary to popular belief, larger or oversized air conditioners don't cool rooms faster – installing a system that's too big for your home can lead to uneven cooling and temperature swings. Similarly, too compact units work overtime to cool the air, leading to quicker wear and tear and reduced cooling capacities.

THE FIX: Pick the right-sized units for your space. As a general guideline, figure out the room's square footage and multiply that by 70 for the accurate BTU (British Thermal Units) needed. Add or take away 10 per cent of that number depending on how warm or cool the room gets. Gain City's team of air-con specialists can help new homeowners make suitable selections. Get started at www.gaincity.com/airconservice.

MISTAKE:

Skipping regular maintenance

As mentioned earlier, neglecting routine air-con servicing leads to more problems in the long term. Beyond the usual maintenance, trained technicians can identify potential issues before they escalate. This way saves you more time, money and effort as compared to fixing a malfunctioning air-conditioner.

THE FIX: The air-con filters and evaporator coils are what typically requires cleaning every month. While homeowners can conduct simple maintenance works on their own, we recommend engaging a professional for annual servicing to reduce the need and frequency of costly repairs.



Scan this QR code for an informative video on Gain City's air-con maintenance services!





MISTAKE:

Using the wrong thermostat settings

Eager to cool off? Blasting your air-con on the lowest thermostat settings won't cool the room any faster, as the air-con system is designed to push out the same amount of air, no matter the temperature setting. Instead, this habit overexerts your unit and contributes to higher electrical bills. Frequent thermostat adjustments can also cause problems because it forces the air-con to switch gears constantly, leading to quicker wear and tear.

THE FIX: Exercise patience, or opt for a programmable thermostat in your next air-con upgrade so you can set or reset temperatures before stepping into the room.

MISTAKE:

Not changing the air filter

The longer the filter is in place, the more dirt, dust and allergens it traps. Clogged filters decrease the efficiency of the air-con unit, resulting in higher electricity bills.

THE FIX: Three months is the standard for how long to go before changing your air filter – a month for warmer periods with heavier air-con usage. Homes with pets or people with allergies should see air filter swaps every 20 days or so. It's also advisable to check and change the filters after dusty renovation work.



MISTAKE:

Not replacing your air-con unit

There are many symptoms that signal an impending replacement of your air-conditioner, including moisture and leakage, diminished airflow, unusual noises, the need for frequent repairs and more. At its best, a well-serviced air-con can last around 10 to 20 years before needing a replacement – shorter still, for ill-maintained units. Extending the use of an air-con past its intended lifespan can lead to increased repair costs and incur heavier energy consumption as the unit functions less efficiently.

THE FIX: Before taking the plunge, seek the opinion of air-con professionals. Gain City's team of experts are here for you, with affordable packages for every budget.

Find out more at www.gaincity.com/airconservice.



frequently used A/C MODES, EXPLAINED

NOT ALL SYMBOLS ARE MADE EQUAL. HERE'S ALL YOU NEED TO KNOW ABOUT THE DIFFERENT MODES IN AN AIR CONDITIONER – AND HOW TO MAXIMISE THE FUNCTIONS.



COOL MODE

See a snowflake symbol? This is the default mode that your air conditioner operates in, which produces instant cooling results. Its main function is to bring in hot air and run it through the compressor to generate cold air. Once your desired temperature is achieved, the compressor shuts off automatically while the fan continues running to keep the air regulated. The cool mode works best if you want to maintain a consistently cool temperature throughout your home. We recommend keeping it at around 25 degrees Celsius to avoid overworking your unit.



DRY MODE

Often categorised as a water droplet symbol, the dry mode works by reducing the amount of moisture in the air to maintain humidity at comfortable levels. Think of it as a dehumidifier – air gets dried down in the evaporator, before being released back into the room. As it does not blow out cold air, using the dry mode consumes far less energy than the cool mode. This function would be ideal during times of the year where the weather is increasingly humid, such as the monsoon season. Pull up the dry mode during colder months like December and January!



GREE'S 5 STEPS FOR AIR PURIFICATION AND CLEAN BREATHING

About Gree

Founded in 1991, Gree Electronic Appliances Inc. of Zhuhai, China, is a well-established home appliance brand.

A far cry from its humble beginnings as a small factory that assembled residential air conditioners, Gree has grown into an international home appliance enterprise after more than 30 years of development. Gree is currently the largest air-conditioner manufacturer in China and globally in terms of production capacity. The annual production of residential (RAC) and commercial air conditioners (CAC) is over 60 million and 5.5 million sets, respectively.

Now, Gree ranks 246th on the Forbes Global 2000 and 436th on the Global Fortune. According to Nikkei, Gree's global market share of residential air conditioners reached 20.6 per cent in 2018, ranking 1st in the world for two decades.

Gree now has 15 production bases globally – 13 are located in China, 2 in Brazil and Pakistan, with more than 90,000 employees. Gree firmly persists in the business philosophy of passion, innovation and realisation. It aims to build a century of standing in the air conditioning enterprise to create a better life for humanity.

Step 1



Initial Filtration

The air conditioner features an integral overhead filter that blocks out airborne impurities. From removal to cleaning, there's no need for dismantling, enabling easy maintenance at all times.

Step 2

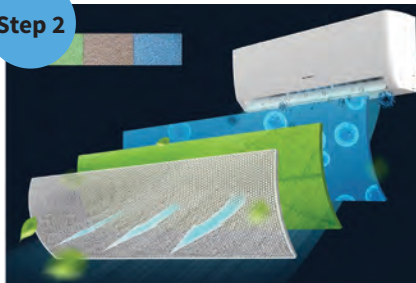

Step 2: Deep Cleaning

Antibacterial tricolour filters remove dust, allowing the whole family to breathe cleanly and safely.

Step 3



Whole House Purification

Gree's Colasma air purification technology helps achieve whole house purification by deodorising and inhibiting bacteria growth.

Step 4

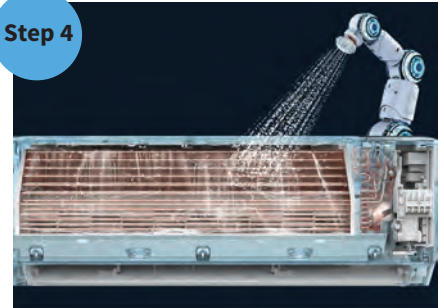

Step 4: Self-Cleaning Technology

Gree's air conditioners enable efficient auto clean in four steps. The brand's innovative evaporator auto clean tech, as well as the process of condensing, frosting, sterilising and defrosting enables quick odour and dirt removal, allowing users to breathe freely.

Step 5

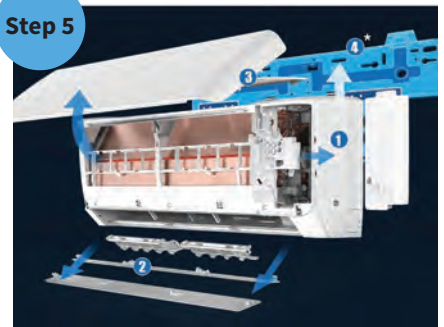

Step 5: Easy Cleaning

Dust is effectively prevented with a fully closable air outlet. The clasp design of the air outlet makes it easy for users to dismantle and clean, thus ensuring a cleaner air supply.

SG-Gree Pte Ltd is the exclusive distributor of Gree's brand of air-conditioners, air purifiers and home appliances in Singapore.



HEAT MODE

The heat mode typically appears in the form of a sun, and it's exactly what it sounds like: to heat up your home. The airflow is now reversed, which means that the compressor now supplies warm air into the room and pushes cold air out into the environment. While this function might not often be utilised in Singapore's year-round tropical climate, it would definitely be a useful feature during winter months in other countries.



FAN MODE

If you don't require a significant amount of power cooling, the fan mode should do the trick. Usually represented by a fan symbol, this activates the built-in fan within the unit instead of the compressor to circulate the air more efficiently. This mode helps to keep your home cool and well-ventilated while operating at a more energy-efficient level, allowing you to save more on your electricity bills.



AUTO MODE

The auto mode is depicted as the letter "A" housed inside a border of arrows. Similar to the cool mode, turning on the auto function keeps your machine in functioning order to maintain a specific set temperature. After you've reached your desired temperature, the compressor (and sometimes even the fan) will then be switched off to conserve more energy.



ECO MODE

For the eco-conscious, the eco mode is your go-to setting. The symbols vary across manufacturers – some look like a leaf, others look like a thunderbolt. Regardless, they all serve the same purpose: to save energy. While it does the same job as the cool mode, the eco mode runs the compressor at a lower cooling capacity so minimal energy is consumed.

Ever wonder what's the meaning behind those symbols with mysterious strokes of air? Known as the vertical or horizontal air swing, these two symbols allow you to control the direction of your airflow for optimal cooling and heating effects.

It's important to understand the various functions in your remote control to get the most out of your air conditioning functions. Be sure to read up on the product's user manual, or visit the manufacturer's website to get more information prior to installing!

Breathe EASY

REFRESH YOUR HOME WITH THIS HANDY GUIDE FOR CLEANER, FRESHER-SMELLING AIR ALL DAY.

having a bad air day? You might want to check on what you're breathing in at home. It's said that pollution levels can be up to five times higher as compared to outdoor air, which poses a serious health risk for you and your family members. To improve your indoor air quality, consider air purifiers and humidifiers to keep your air healthy, clean and pollutant-free. Read on to get the full lowdown on the benefits of air purifiers and humidifiers, and how you can pick the right one for your needs.

Air purifiers vs humidifiers

UNSURE ABOUT THE DIFFERENCE BETWEEN AN AIR PURIFIER AND A HUMIDIFIER? WE CLEAR THE AIR ON HOW EACH DEVICE WORKS SO YOU CAN USE THEM MORE EFFECTIVELY.

AIR PURIFIER

If you're worried about household pollutants lurking in the air, an air purifier will do just the trick. This nifty gadget filters out a wide range of airborne contaminants such as dust, smoke, pollen and dander to reduce air pollution. Typically, it works by sieving out icky particles through an array of filters, and then releasing clean air into the room. The golden standard is to choose one with a high-efficiency particulate air (HEPA) filter, which is able to remove up to 99.7 per cent of airborne particles as little as 0.3 microns in size.

PROS: An air purifier is capable of removing allergens and triggers from the air, which is helpful for folks dealing with allergies, asthma, or other respiratory issues. And unlike humidifiers which work best for dry conditions, air purifiers can be utilised at all times to maintain clean, breathable air.

CONS: Be mindful to avoid electronic air purifiers. These models are known to release ozone as a byproduct into the air, which can be potentially harmful when inhaled, rendering them unsuitable for residential use. HEPA-based air purifiers are 100 per cent ozone-free, and makes for a safer option.



OUR PICK: Boasting air purification in less than eight minutes, the **Philips Air Purifier AC2936/33** is an ideal solution for residential and small office settings with decent coverage of up to 98 square metres. The innovative gadget features three-layer filtration with NanoProtect HEPA and an active carbon filter capturing 99.97 per cent of ultra-fine particles as small as 0.003 microns to get rid of PM2.5 pollutants, bacteria, allergens and odours more effectively. Other cool features include remote monitoring and control via the Clean Home+ app and auto-ambient lighting for a more seamless experience.

HUMIDIFIER

It's important to keep humidity levels at optimal levels (approximately between 30 to 50 per cent) to combat the woes of dry air. A lack of moisture in the air causes a whole host of symptoms including dry skin, cracked lips and even the occasional nosebleed. As its name suggests, a humidifier delivers moisture into the air in the form of a mist to increase the overall humidity. Besides eliminating dryness, it also helps to create a more comfortable environment for your loved ones to live and breathe in.

PROS: Beyond the health front, using a humidifier can also help to protect wooden items from damage. Poor humidity levels can cause wood furniture to split and crack, and even lead to gaps in wood floors.

CONS: Frequent cleaning is required to prevent the accumulation of bacteria, mold and mildew. We recommend cleaning out your humidifier every three days to keep it working well!



4 things to know before buying an air purifier or humidifier

1. KNOW YOUR NEEDS

Think about it: do you want to reap the purification benefits, or are you in need of a humidity boost? Although air purifiers and humidifiers can both be used to improve the quality of indoor air, each device serves entirely different purposes so it's best to choose one that fits your needs.

2. CONSIDER THE FEATURES

Not all air purifiers and humidifiers are made equal. When it comes to selecting the right product for your home, look out for certain features that will help to enhance its effectiveness – think user-friendly settings, energy-saving capabilities, air quality indicators and more.

3. FIGURE OUT THE PLACEMENT

Keep in mind that both machines are primarily designed to function in the room it's placed in, so you might want to invest in dedicated units for each space. An air purifier might work best in the living area since that's where you spend most of your time in, while a humidifier is ideal for air-conditioned rooms such as your bedroom or study.

4. DON'T FORGET ABOUT MAINTENANCE

Regular upkeep is essential in ensuring that your devices are in working order. Humidifiers have to be maintained every few days, while air purifiers typically require filter replacements every three to six months. A HEPA filter should be changed at least once a year, depending on usage.



OUR PICK: Want the best of both worlds? For those who prefer a fuss-free option that does it all, look no further than the **Sharp Humidifying Air Purifier KCG60EW**. With a three litre tank capacity, this powerhouse doubles up as a humidifier to fill the air with adequate hydration in a 30 square metre space. What's even more impressive is that it operates fully in intelligent mode with just the touch of a button – just turn it on and let it run automatically!



WHAT'S **Smart?**

STAY PRODUCTIVE

Work smarter, not harder from the comforts of home with these cool innovations.

TINY but mighty

SMARTEN UP WITH THESE SMALL HIGH-TECH
UPGRADES THAT WILL MAKE YOUR HOME LOOK
BETTER AND WORK SMARTER.



Keep an eye out

A good security system will help to keep your home safe and secure. The good news is that you don't have to spend a fortune on a full-fledged setup — all you need is a smart surveillance camera to monitor everything at home. The **mydlink Smart Full HD Wi-Fi Camera** packs plenty of advanced features into its compact body, including AI smart motion detection and wireless encryption for enhanced privacy. What's more, you can even link it to your existing smart home devices to keep you connected at all times. Works great as a pet or nanny cam if you ask us!

Make the switch

Fancy controlling your lights with the touch of a button? Switch out your plain bulbs for smart lighting like the crowd-favourite **Philips Hue White and Color Ambiance LightStrip**, which allows you to adjust brightness, change colours (choose from 16 million colours and 15,000 shades of white!), and more via an app, or with just your voice. Add these snazzy light strips wherever you'd like, be it under kitchen cabinets, around bed frames, or behind your TV. Plus,

it's easy to set up; just pair it up with a voice assistant, and let it do the rest. Need more light coverage? Easily snap a Philips Hue light strip extension to your base kit, and enjoy full colour consistency from start to finish.



Pull the plug

Got a power outlet? Stick a smart plug in it. These nifty little adaptors turn any electrical outlet into a smart socket, allowing you to control, manage and monitor any device straight from your smartphone. The **TP-Link KP115 Kasa Smart WiFi Plug** is a great contender, especially with its Energy Monitoring feature that provides an overview of your connected devices' real-time energy consumption. Pair this data with the smart plug's Schedule and Timer functions to reduce unnecessary energy usage and lower your electric bills. For even more convenience, pair your smart plug with Alexa, Google Assistant or Samsung SmartThings to enjoy hands-free voice control.



Ditch your keys

If you're not a fan of the traditional deadbolt, digital locks are a keyless solution that will automatically lock and unlock your door in an instant. Touted as the world's first push-pull digital lock, the **Samsung SHP-DP728**, is a versatile gadget to start with as it offers advanced unlock authentication methods like Bluetooth, fingerprint, RFID card and passcode unlock options. There's also an activity log that you can view through an app so you can easily keep track of who comes in and out. How convenient is that?



One-stop solution

If you've got a myriad of gadgets, you might want to consider investing in a smart automation system to keep your setup running smoothly. A smart hub serves as the main command centre of your entire smart home ecosystem, giving you seamless control over all your devices. **Samsung SmartThings** works with everything from lights to air-conditioners and refrigerators under the range of the SmartThings-compatible device, all in real-time via the app. A perfect addition to your home if you're looking for a fuss-free solution that does it all!



HOME OFFICE essentials

FROM TECH UPGRADES TO DESK ACCESSORIES, WE ROUNDED UP THE TOP WORK-FROM-HOME ESSENTIALS THAT'LL SET YOU UP FOR MAXIMUM PRODUCTIVITY.



Ergonomic chair

Feeling achy from sitting down all day? It might be time to invest in an ergonomic office chair to get you through the long hours. Not only does it offer better neck, arm and back support, it also helps to keep your posture in check so you can work more efficiently. We love the **Morrison Office Chair**, which comes with decent lumbar support and an adjustable headrest for extra comfort.

Mechanical keyboard

If you're someone who spends a lot of time typing, go for a classic mechanical keyboard. It comes with clicky, spring-loaded key switches for improved typing performance, making it ideal for both work and gaming. A clear favourite is the **ASUS Rog Claymore II BL**, which is built with optical switches and customisable hotkeys for the full tactile experience. Did we mention that it's rainbow backlit too?



Noise-cancelling headphones

From highway traffic to noisy neighbours, it can be a struggle to stay focused when you're working from home. A sturdy pair of noise-cancelling headphones will do just the trick in blocking out any distractions while you get your work done. The **Sony Wireless NC Headphones** is a great option that is capable of eliminating ambient noise, while delivering excellent sound clarity to enhance your listening experience. It's also equipped with a built-in mic for those who are frequently on calls.





STYLE AND SPEED

Introducing the latest Microsoft Surface Laptop 4 – a powerful, sleek touchscreen device for multitasking speed, productivity and entertainment.



The way we live has fundamentally shifted. With most interactions being virtual, staying connected is a priority made sustainable with the proper devices. Enter the Microsoft Surface Laptop 4 range, touchscreen ultraportables that offer serious multitasking power for both work and play.

The Surface Laptop 4 range retains the iconic design features of its predecessor while packing heavy upgrades in an incredibly svelte chassis that weighs only 1.5kg for its 15-inch model. A variety of customisations are available, from aesthetic

to functional. For starters, users can customise their keyboard and trackpad with either Alcantara or metal finishing. Beyond its good looks, the Alcantara fabric is relatively durable and stain-resistant. It is also sustainable, 100 per cent cruelty-free and carbon neutral, which is perfect for eco-conscious folks.

Even more exciting is the option to configure the Surface Laptop 4 with either 11th Gen Intel® Core™ processors or AMD Ryzen™ Microsoft Surface® Edition processors for both its 13- and 15-inch models. These CPU upgrades pack a

serious punch, delivering a seamless performance of up to 19 hours of use on a full battery charge.

The Surface Laptop 4 is no slouch in the graphics department either. It offers integrated Intel® Iris® Xe graphics or AMD Radeon Vega 8 graphics that provides zippier photo or video editing speeds of up to 70 per cent faster than its predecessor. Coupled with Microsoft's signature 3:2 PixelSense high-contrast touchscreen display and Dolby® Atmos™ Omnisonic speakers, this laptop promises immersive 4K cinematic entertainment even while you're on the go.

Other work-friendly features include a built-in HD camera backed by Studio Mics for high-quality video calls, even in low light. And Microsoft's Windows Hello face recognition feature that unlocks the Surface Laptop 4 in seconds.



Compact printer

We all need a trusty printer to print out work documents, business reports, or even homework assignments for your kids. And you don't need a chunky one either – the **Epson Inkjet Color Printer** is your machine. Small and portable, this fuss-free unit makes printing, scanning and copying an absolute breeze thanks to its wireless connectivity, which allows you to churn out documents even without a laptop. Perfect for everyday print jobs!

Wireless charger

Keep a wireless charger handy to make sure your devices stay powered throughout the day. The **Energizer Wireless Charger** is a good one to have around – it's designed with ultra-high output that can support fast-charging for any compatible devices, including Samsung, Huawei and LG. It comes in an incredibly thin and sleek design that can be discreetly stored on your desk, sans the messy cable clutter. Just place your phone at the centre of the charging pad, and wait for it to get juiced up!



Best Laptops For Work

Those who are desk-bound can get away with a bulky monitor, but if you're constantly lugging your laptop between work meetings, a portable device will come in handy.



For the everyday professional: Lenovo IdeaPad Slim 3

Breeze through your everyday work tasks with this compact yet powerful workstation. Designed for the stay-home warriors, the **IdeaPad Slim 3** is equipped with a plethora of smart learning solutions for a more seamless workflow. With features such as enhanced eye care and posture detection, it's also great for kids who are doing home-based learning. Talk about an all-in-one machine!



GOING GREEN?

The Acer Aspire Vero is a trusty device that hits productivity and sustainability goals.

Designed to be easily repaired, upgraded and recycled, the Aspire Vero is the brand's first laptop to put PCR (post-consumer recycled) plastic at the forefront. The flagship product is part of Acer's Earthion (an amalgamation of the words "Earth" and "Mission"), an initiative that tackles environmental challenges through innovative and integrated solutions.

For starters, the Aspire Vero reflects Earthion's mission and values by using PCR plastic throughout the device's volcano grey chassis with yellow pigments and keyboard caps and takes it a step further with eco-friendly packaging. 80 to 85 per cent of the packaging is made from recycled paper pulp, while a paper sleeve houses its adapter instead of plastic. And 100 per cent recycled paper is used where plastic can't.



After use, the already-recycled packaging is also 100 per cent recyclable and easily dismantled, thanks to easily accessible standardised screws. Users can even reuse a part of its packaging into a laptop stand.

Under its sustainable hood, an 11th Gen Intel® Core™ i7 Processor powers the Aspire Vero, along with 512GB M.2 PCIe SSD storage. Enjoy its 15.6" FHD IPS display in full glory with the Aspire Vero's narrow bezels – plus Acer TrueHarmony™, Acer PurifiedVoice™ with AI noise reduction for smoother online meetings.

Its slightly raised keyboard enables ergonomic typing. Look out for its highlighted and mirrored "R" and "E" keys that symbolise the three "Re's": Reduce, Reuse and Recycle. The eco-friendly device also features Wi-Fi 6 for improved connectivity and a Type-C and three Type-A ports for convenient accessorising.

Create an inspiring and productive workspace with these easy decor tips.

1 GIVE IT A PAINT REFRESH
Give your boring office a chic update with a fresh pop of colour. Besides transforming your space, choosing the right paint colours can even help to boost your productivity – think calming greens, stimulating yellows and earthy browns.

Not keen on getting your hands dirty? Gain City is offering professional home painting packages by Nippon Paint, which comes with free wall inspection and 12-months warranty. Find out more at Gain City's website!



2 FOCUS ON LIGHTING
If your home office isn't blessed with a ton of natural light, it's a good idea to add task lighting to brighten up your desk. Look for a desk lamp that offers just the right amount of light to stay focused without causing any strain to your eyes.



3 CREATE A COSY CORNER
Have an odd little nook? Don't let that pocket of unused space go to waste. Instead, carve out a cosy reading nook where you can unwind after a long day. This intimate corner is the perfect spot to enjoy some quiet time while lounging away.



4 ELIMINATE VISUAL CLUTTER
Tangled cords and messy cables can be frustrating to deal with. An easy fix? Just go wireless! Going cable-free not only makes your space look neater, but also helps you to stay connected – without actually being connected.



5 INCORPORATE STORAGE
Keep your workspace streamlined and organised with smart storage solutions. If built-ins are not possible, movable storage units are a great way to hide away unsightly paperwork, stationery and other bulky items.



ZEN den

RELAX AND UNWIND WHILE THESE SMART HOME APPLIANCES DO ALL THE WORK.



Turn your TV into artwork

There's nothing like a beautiful piece of art to bring life into your space. We're not talking about paintings, but Samsung's iconic **The Frame**. Not your ordinary TV, this device comes with a special art mode that turns the screen into a blank canvas to display all your favourite artworks in brilliant QLED 4K glory – It's like having your very own private art gallery. Not at home? Its motion sensor technology detects the moment when you leave the room, and turns itself off instantly.



Stay cool all day long

Is the sweltering heat bogging you down? Chill out in the comfort of your home with the upgraded **Toshiba YouME 2.0 series** that boasts a five-tick Low Global Warming Potential (GWP) Inverter Multi-Split. It comes packed with nifty features such as a redesigned fan for quicker cooling and Smart Control options with the new Toshiba Home AC Control app. Plus, it's able to capture up to 94 per cent of PM2.5 particles thanks to its UltraPure Filter. With a cooling unit this intuitive, all you have to do is sit back and enjoy your air-con fix.

Pamper yourself with a spa day

Your shower routine just got a lot easier with the **Ariston Aures Smart Round**. Designed to provide a new level of comfort, this electric water heating system is powered by smart sensors to maintain the perfect temperature throughout your shower, and has an added safety function that prevents you from getting scalded by hot water. It's also water and energy efficient so you can take a long, good soak without worrying about your utility bills.



Indulge in aromatherapy

Infusing the right scent into your space not only creates a calming ambience, but also comes with a slew of health benefits from enhancing mental clarity to improving sleeping patterns. For a truly immersive experience, try the **Novita Aroma Diffuser**. Using advanced ultrasonic technology, it comes with LED ambient lights to set the mood, and a mist timer that allows for continuous output or at intervals until the unit switches off automatically. Just add in a few drops of essential oil, and fill the room with your favourite scent!



bright IDEAS

DON'T BE LEFT IN THE DARK - WE SPOTLIGHT THE TOP LIGHTING TRENDS THAT WILL INSTANTLY BRIGHTEN UP EVERY PART OF YOUR HOME.



TIP: Opt for LED lighting instead of traditional fluorescent lights. It consumes less energy, generates little to no heat, and has a long lifespan so you won't have to worry about replacing it.

For the living room

Cosiness is key when it comes to the living room. Instead of ceiling lights, go for ceiling fans that double up as a lighting solution. Gone are the tacky designs of yesteryears; these trusty breeze-makers now come in a myriad of decor styles that are sure to look great in any modern living space. For instance, the **KDK U48FP** comes with built-in LED lighting that not only illuminates the area, but also helps to keep your home cool, comfortable and ultra-stylish.



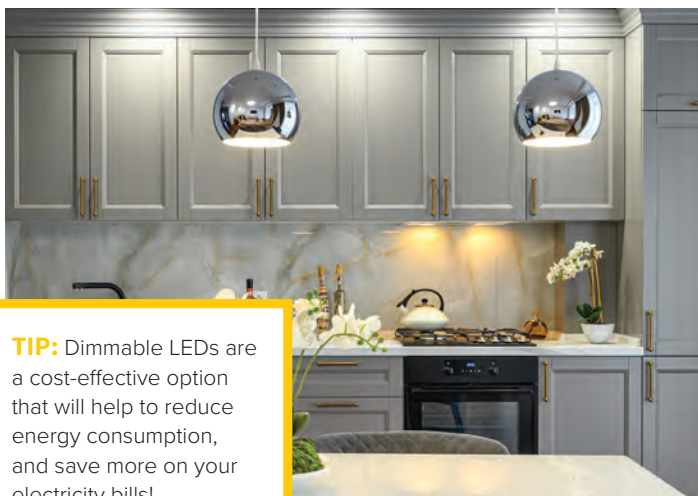

TIP: Dimmable LEDs are a cost-effective option that will help to reduce energy consumption, and save more on your electricity bills!

For the dining

Old-fashioned light bulbs just don't cut it anymore. Dimmable light bulbs like the **Megaman LED Filament Bulb** are now in demand, as it allows you to control the brightness levels to suit your surroundings. During dinnertime, dim the lights to set the mood for a warmer ambience – perfect for an intimate date night with your partner. What we love about the Megaman range is that it sports the iconic golden filament bulb, which brings a classic vintage feel to the table. Talk about having an Edison moment!



TIP: Studying in poor lighting conditions can cause eye fatigue. Look for lighting with glare protection functions that will shield your eyes from unnecessary damage.

For the study

Add functional task lighting to dedicated areas such as the study so you can work in a well-lit environment. A desk lamp like the **3M Polarizing Task**

Light provides a useful light source that will help you to stay focused and alert. It comes with multiple brightness levels that you can easily adjust, as well as an anti-glare filter that offers you greater reading comfort. What's more, it also serves as a mood light to create a calm and pleasant atmosphere where you can relax in.

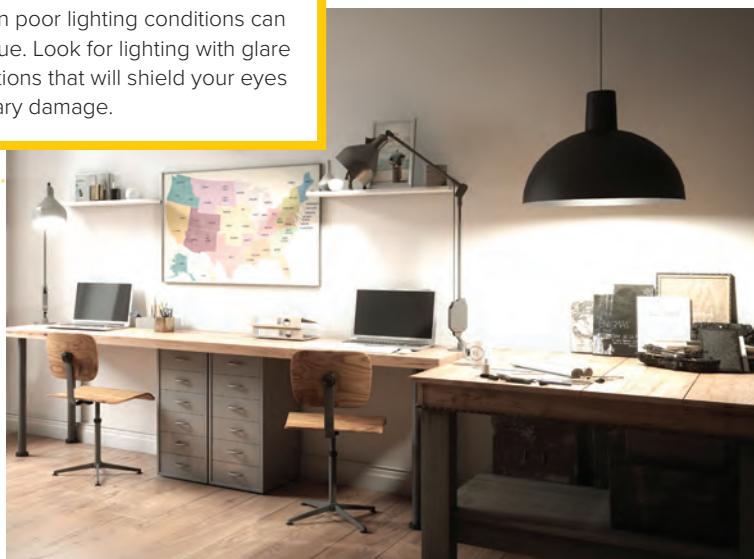

TIP: Prolonged exposure to ultraviolet rays can cause damage to your eyes and skin, so ensure that the UV lamp comes with additional safety features for an extra layer of protection.

For the bedroom

Your bedroom is your ultimate safe haven, so you would want to keep the space clean and germ-free. Leave it to the **Philips UV-C Disinfection Desk Lamp**, which utilises UV-C technology to get rid of bacteria and viruses (yes, including the coronavirus!) within the room in just a matter of minutes. The best part? It looks just like an ordinary lamp – simply place it on your bedside table and let it do its thing. Just be sure to leave the room before switching it on to prevent getting hit by a blast of UV!



HOME THEATRE SETUPS for every budget

RECREATE THE ULTIMATE CINEMA EXPERIENCE AT HOME WITH
THESE BLOCKBUSTER-WORTHY ENTERTAINMENT GEAR.

TVs

Looking to upgrade your old TV setup? There are plenty of big-screen contenders in the market, from LCD to QLED, 4K to smart TVs. A TV also offers better performance in terms of picture quality, colour capabilities and sound output – all in a sleek, ultra-slim form factor.



TO SPLURGE: LG OLED THINQ SMART TV

The **LG OLED TV** is a sight to behold. Featuring an innovative luminous technology, this 77-inch beauty comes with millions of self-lit pixels to achieve the perfect colour contrast, resulting in bright and crisp visuals no matter the lighting conditions. Unlike its LED counterparts which can often be restricted by backlight, LG's OLED screens are capable of producing unique and hyper-realistic imagery like no other. Plus, it's a lot safer and more comfortable for your eyes thanks to its low-blue light, glare-free display. To maximise your TV experience, simply set it up with a voice assistant for complete command and control.



TO SAVE: SONY LED SMART TV

For more bang for your buck, the **Sony LED Smart TV** offers unbeatable value for its price point. Powered by Sony's X-Reality Pro engine, this 32-inch unit ensures HD-ready quality for every pixel so you don't have to worry about streaming in low resolution. It also comes with built-in Wi-Fi, as well as a screen mirroring function that lets you access all your smartphone content on the big screen. You can even record down your favourite movies and TV shows onto an external USB drive to watch whenever you like. Netflix binge, anyone?

Projectors

If you're not a fan of bulky televisions, consider opting for a projector screen to create a more cinematic feel. It fills up an entire wall without taking up a smidge of floor space, hence minimising visual clutter and makes for a more seamless viewing experience.



TO SPLURGE: SAMSUNG THE PREMIERE SMART LASER PROJECTOR

For the serious cinephiles, **Samsung's The Premiere** delivers on all fronts – a massive 120-inch wide screen, ultra-high 4K resolution quality, and a powerful built-in audio system to match. This one features an ultra short throw design that allows you to set it up anywhere, even when it's positioned close to the wall. As a bonus, the projector also comes with smart TV features so you can enjoy the same intuitive interface and streaming services under the Samsung system.



TO SAVE: XGIMI HORIZON PRO

If you're looking for a slightly more affordable option, **XGIMI's Horizon Pro** packs a serious punch despite its compact size. Its specs are impressive: a full HD resolution, true 4K clarity, and even a built-in AI sensor to adjust ambient brightness so you can enjoy your content in detail without being interrupted. It runs on Android TV so you can connect it to your favourite video streaming apps to give you instant access on the go, allowing you to stay plugged in anywhere.

Audio

Complete your home cinema setup with a powerful surround sound system. Soundbars and speakers are both great options that will enhance your built-in audio quality, while delivering a truly immersive, theatre-like experience.



TO SPLURGE: SAMSUNG HW-Q950A 11.1.4CH SOUNDBAR

For a no-fuss audio solution that offers excellent performance, the **Samsung 11.1.4ch Soundbar** is your best bet. Utilising the latest technologies from Dolby Atmos and DTS:X, this sleek powerhouse comes with HDMI connectivity, a wireless subwoofer channel, and 3D audio technology to achieve multidimensional sound from all directions. It's also Wi-Fi and Bluetooth-enabled so you can sync it with your TV sans the wires, and control key sound functions with the Samsung TV remote – straight from your TV. It works with Apple devices too!

TO SAVE: SONY MHC-V42D HIGH POWER AUDIO SYSTEM

Speakers are usually on the pricier side, but the **Sony MHC-V42D** is a solid gadget that gets the job done. With its jet bass booster function, this party box fills the room with dynamic changing lights and superb bass sound so you can feel every beat. Music aside, it offers plenty of home entertainment thrills too. Just hook it up to your TV and you're ready to enjoy an epic night of movies, dramas and sports in cinematic fashion. For an extra boost, you can also connect up to 50 different audio devices for a more amplified output. Now you're all set to get the party started!





WHO'S **Home?**

GET INSPIRED

A celebrity tour of Gain City's show flat at
Megastore @ Sungei Kadut.

celebrity TOUR

AN EXCITING TOUR OF A SHOW FLAT AT GAIN CITY MEGASTORE @ SUNGEI KADUT AWAITS! OUR CELEBRITY GUIDE, LOCAL ARTISTE MEIXIN MACY, INTRODUCES HER FAVOURITE INTERIOR FEATURES, ALONG WITH HOME DECOR TIPS AND TRICKS. SHE ALSO GETS PERSONAL WITH CITY LIVING, OPENING UP ABOUT FAMILY, CAREER AND LIFE PHILOSOPHIES.



Meixin Macy, Artiste



Enjoy tasty yet healthful meals with the multifunctional Toshiba Pure Steam Oven. Home chefs will enjoy its versatile cooking functions: three steam modes, convection baking and frying options to cater for different tastes and dishes.

You've just finished filming *My Mini-Me and Me*. How was that experience?

Meixin: My character is well-versed in wing chun, which made my experience exciting yet physically challenging. The short wig I wore was always drenched in sweat, especially after fight scenes. We also filmed at an old factory, and it was so dusty that my nose became very congested after a full day on set. Besides that, I remember having to cycle with Xu Bin (artiste) riding pillion. Because of the weight difference, he often had to help me kickstart the bicycle, which was hilarious.

How was it like filming during the pandemic?

Meixin: It took some time getting used to, as we had to wear face shields and masks – the precautionary measures were impeccable!

What do you typically do after filming? Do you have any self-care rituals?

Meixin: Netflix, my bed and a glass of wine are what I prefer to help me unwind after a long day. Suppose I was in a harsher environment like the factory. In that case, I'll make sure to switch on my air purifier, which filters out fine particles to help me breathe better. I love aromatherapy as well, so I use subtle, organic scents to relax.

I like to take longer breaks after filming wraps, as acting does take a mental and physical toll. I even took a hiatus off acting to study interior design.

What's one of your most memorable works to date?

Meixin: Probably *Long Long Time Ago: Diam Diam Era*. The role was new to me, and the director, Jack Neo, understandably had high expectations. We could spend around 14 to 15 hours filming a single scene. In actuality, every role is memorable as I have different feelings and emotions tied to each character. You can check out *Diam Diam Era* on Netflix. Some of my other works, such as *Mind Jumper*, are available on meWATCH, so do check those out too.

Do you have any roles or projects that you'd like to try?

Meixin: I want to play a strong 'gangster', kind of like Thirteenth Aunt in *Once Upon a Time in China* or [Shu Qi's character in] *My Wife is a Gangster 3*. Outside of acting, I dream of buying my own place where my family can be comfortable.

You're very family-oriented! Where in your home do you spend the most time together?

Meixin: Definitely the living and dining areas. My family enjoys having meals together, where we'd eat, sit and chit chat. I've learned to prioritise what's important, and for me, it's my family. I'm very blessed with good friends and loved ones, and I hope to experience life to the fullest with them.

You've travelled extensively. What makes Singapore home?

Meixin: I've gotten homesick while filming in China. I believe that home is where love is. And for me, love is my family! That's why I've chosen to stay with my parents, and I love spending time with them.

You're quite the philosopher! Is this a side of you that people rarely see?

Meixin: It's interesting because how I look doesn't necessarily reflect how I speak or my life's philosophies and values. People think that I'm quiet, but I'm more loud and easygoing than anything else. I'm pretty unbothered by things as I believe it makes life much easier.

Life can be rather stressful at times, so I like to keep things simple. Take a step back, meditate and relax, or cosy up in bed with a glass of wine. It's a surefire fix for me, no matter how tough my day was.





This design is ideal for a kids' bedroom that grows with the child. The room's main feature is a raised platform bed with storage cubbies to keep clutter at bay. And the adjacent desk is a functional yet stylish workspace solution for smaller spaces.



Be it work or play – the Microsoft Surface Laptop 4 delivers multitasking speed, style and entertainment in one powerfully sleek touchscreen device.



Breathe easy with the Electrolux Pure A9. It features the PureSense system, which allows automatic adjustments to air purification rates and the AirSurround system for efficient circulation and cleansing of indoor air.

Personal space can be challenging when living with family. What are some tips when it comes to designing a family-friendly home?

Meixin: Well-planned communal areas are places where everyone feels comfortable. So space planning comes first. There are many considerations, such as who's using the space. List down their habits and lifestyle requirements to better cater for their needs.

Then plan for ample storage space, which is especially important for families with young kids. After that, start thinking of your preferred interior design styles and colour palette.

Also, consider your family's habits. If you watch TV together often, then the living room is essential. If you bond over food,

then prioritise the dining area. With homes getting smaller, you have to be more creative and unconventional when finding solutions that work for you.

What are some must-have appliances for your eventual forever home?

Meixin: I'll have a big TV; all the better for me to enjoy a movie and relax! A decent audio setup is a plus. Beyond that, I like appliances that bring convenience – a microwave and two-in-one washer-dryer are must-haves too. I'll likely check out Gain City's New Homeowner's Group Buy Programme for even more home appliance discounts and deals.

Follow Meixin Macy on Facebook and Instagram at @meixinmacy for updates on her career, life and other exciting happenings!



WHAT'S **Special?**

LATEST HAPPENINGS & PROMOTIONS

Don't miss out on these exciting events and deals at Gain City!

going greener WITH GAIN CITY

around 60,000 tonnes of electronic and electrical waste (e-waste) gets thrown out in a year. As Singapore's largest air conditioner retailer, Gain City works closely with the National Environmental Agency (NEA) to provide e-waste disposal and recycling alongside other sustainability efforts.

E-TRASH TO RECYCLED TREASURES

Looking to replace your air conditioner? Gain City has been a part of NEA's National Voluntary Partnership Programme since 2018, achieving monthly recycling volumes of over 100 tonnes at our Sungei Kadut e-waste recycling centre. The process includes the safe disposal of harmful gases from air-con compressors and the dismantling and separation of different metals for recycling in an environmentally friendly and sustainable way.



Gain City is also an NEA-licensed e-waste recycler under the E-Waste Extended Producer Responsibility (EPR) scheme that was introduced earlier this year. To play our part towards zero waste, we work closely with the appointed Producer Responsibility Scheme Operator to ensure the proper collection, handling and recycling of e-waste.

Eco-conscious homeowners can opt for our professional disposal and recycling services and receive vouchers and rebates when purchasing energy-efficient air-conditioners from Gain City.

CONVERTING FOOD WASTE INTO FERTILISER

Food waste management is key to conserving precious resources. Gain City Megastore @ Sungei Kadut's two eateries, Happy Café and Lucky Cuisine, effectively collect and processes food waste into fertiliser through the aerobic fermentation system to further support sustainability and environmental preservation.

HOME sweet home

**MAKE YOUR RENOVATION JOURNEY SMOOTHER AND MORE AFFORDABLE
WITH GAIN CITY'S NEW HOMEOWNERS GROUP BUY PROGRAMME.**

purchasing your new home is exciting, even more so when it finally comes to making it your own – which is an extensive and expensive process.

Gain City is here to make it easier with their exclusive New Homeowner's Group Buy programme for all new BTO, resale or private residence dwellers.

This by-invite only event allows new homeowners to snag bundle deals, promos, and discounts off smart home gadgets and home appliances. Think air conditioners, televisions, refrigerators, washers, furniture, mattresses and more from all the major participating brands – all under one roof for your convenience. Want to enjoy more savings with the unbeatable group buy prices? Here's how to get started:



1 SIGN UP
Catered exclusively for new homeowners, the Gain City New Homeowners Group Buy programme attracts plenty, and with good reason. But, the event can only accommodate a limited number of new homeowners in a session, so make sure to register your interest (for free!) at www.gaincity.com/groupbuy to secure your slot.



2

EXPERT ADVICE

Gain City New Homeowners Group Buy programme is designed to be as friendly and informative as possible. But, the sheer amount of products and appliances on sale may be overwhelming for new homeowners. Unsure if a specific product will fit your needs? Approach Gain City's specialists to help you make better, informed decisions.

3

STELLAR SERVICE

Made your purchase? Gain City's journey with your new home doesn't end there. From installation to maintenance, you'll have access to excellent after-sale service for greater peace of mind.

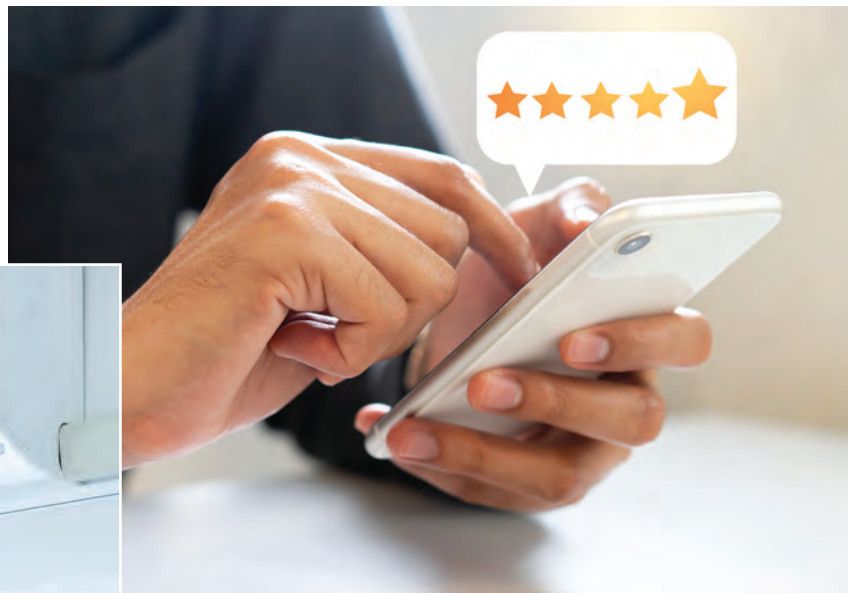

4

BEST PRICES IN TOWN

The offers from Gain City's New Homeowners Group Buy programme are tough to beat. You can enjoy the best group buy deals from all leading electronic brands like Samsung, LG, Sony, and many more. These irresistible buys come with a lowest price guarantee – or a refund of up to 3.5 times the price difference, subject to terms and conditions.

Sign up for the Gain City New Homeowners Group Buy programme now at www.gaincity.com/groupbuy

RELISH THE best shopping privileges!

FLASH THE GAIN CITY FAMILY CARD OR APP AT PARTICIPATING STORES TO ENJOY SWEET DISCOUNTS.



SHOP

Get the most bang for your buck with shopping discounts from **Bata**, **City Chain**, **Goldwood** and **L'zzie**!



DINE

Whether it's treating yourself to local cuisine from **Old School Delights** and tapas from **The Winery** or indulging in Japanese fare from **Hinode Izakaya Bar**, treat yourself to these delicious F&B deals!



PLAY

Enhance your singing skills at **Music Story**, or pick up a good read from **Times Bookstores**, and enjoy cool discounts while at it!



RELAX

Pamper yourself with these wellness deals from **Nailz Gallery**, **Q&M Dental Group**, and **Kinohimitsu**.

www.gaincity.com

Sign up for a free Gain City Family Card membership to enjoy shopping, dining and lifestyle privileges!

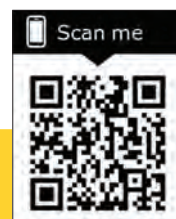

Bata

Get 10% off with a minimum spending of \$40 on regular priced items. Use the promo code 'GCB10' on bata.com.sg to be entitled to the discount.



CITY CHAIN

Get \$5 off your online purchase with the promo code 'GAINCITY5'. No minimum spending required.

GOLDWOOD

Get 10% off regular-priced items online. Visit www.goldwood.sg and apply the discount code 'GAINCITYXGW'.



HINODE IZAKAYA & BAR

Spend \$100 to enjoy a 10% discount off your total bill.



Get 25% off regular priced items with a minimum purchase of \$50.

L'zzie

Get 10% off regular priced items online. Visit www.lzzie.com and apply the discount code 'GAINCITYXLZZIE'.



Enjoy 25% off singing lessons: \$1800 for 16 individual sessions or \$388 for 8 group classes.



Get 6 classic manicure sessions at \$132 (U.P. \$168) or 6 classic pedicure sessions at \$198 (U.P. \$228).



OLD SCHOOL DELIGHTS
Enjoy 10% off your total bill.



Enjoy corporate fixed rates for over 20 dental treatments. More info at Lead.me/CorpRate.



Get 8% off regular priced items with no minimum purchase required.



Get 1 free glass of beer or wine (worth \$12) and a free soft drink for kids below 12 years of age.



Scan the QR code to view the Terms & Conditions.

*Terms and conditions apply

PHILIPS

Television

OLED+ 935



OLED+

The difference is real.

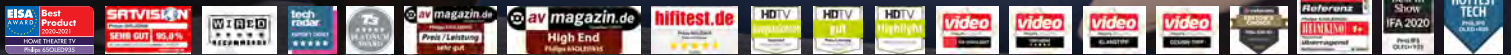

4K UHD OLED+ Android TV

Sound by Bowers & Wilkins

Give your movies the TV they deserve. This stunning Philips OLED+ TV boasts up-firing Bowers & Wilkins speakers, and the latest P5 picture processing with AI. You get a lifelike picture and thrilling sound with crystal-clear dialogue.

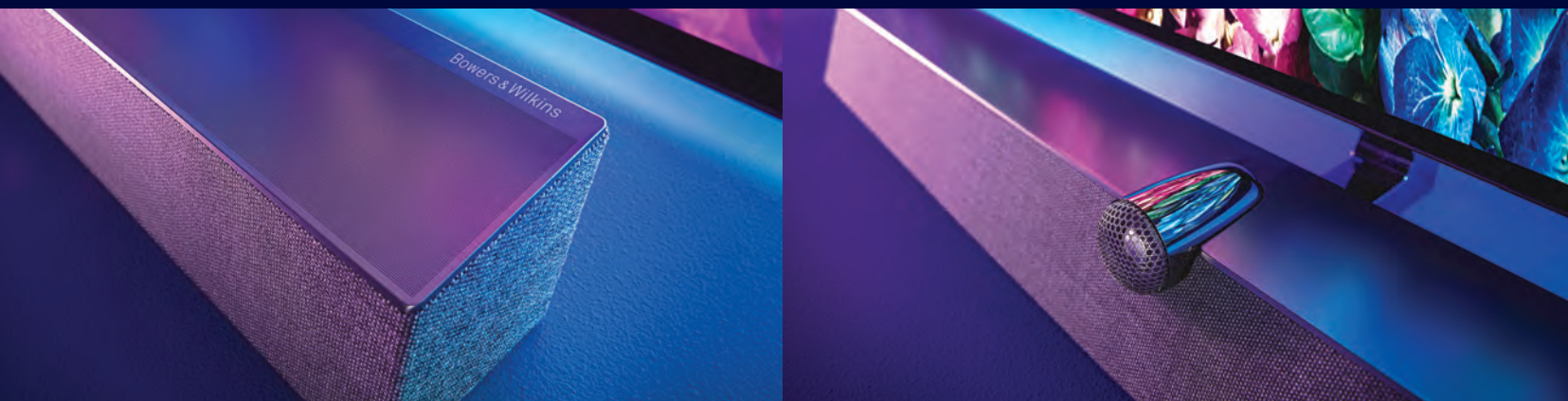

Sound by Bowers & Wilkins

Immersive sound. Bowers & Wilkins meets Dolby Atmos.

An exclusive speaker design by legendary audio engineers Bowers & Wilkins delivers thrillingly lifelike performance. Up-firing speakers let you get the most out of Dolby Atmos. A central tweeter keeps the dialogue pristine no matter how intense the drama gets.



MITSUBISHI ELECTRIC

Changes for the Better



EXCELLENT
Energy
Savings

QUIETEST
19dB

EASY
To Clean!
Easily accessible
Inner vent

Mitsubishi Electric
starMEX
Air-Conditioner



MUY-GN10VA



MXY-2G20VA2



MXY-3G28VA2



MXY-4G33VA2



MXY-4G38VA2

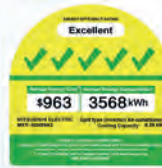

MXY-5G48VA2



MXY-4C100VA



MXY-5C125VA



MXY-6C140VA

WIDE RANGE OF EXCELLENT ENERGY SAVINGS
5-GREEN TICKS AIR-CONDITIONERS IN SINGAPORE

